



Mount'n Mover™

by BlueSky Designs

Download our catalog at:
mountnmover.com/catalog

The Mount'n Mover
wheelchair mounting system

**Move it easily and
independently!**

no tools required



November 2025

Your Eval Kit may not
include all of the items
in this booklet

Mount'n Mover™

by BlueSky Designs

WELCOME TO THE MOUNT'N MOVER COMMUNITY!

BlueSky Designs is proud to bring you its unique mounting solution. Our Mount is manufactured in the US by the same team that designed it with the input of therapists, people with disabilities and their families.

Mount'n Mover's ergonomic controls make adjustments easy. With its simple setup and memory lock positions; your Mount'n Mover will consistently lock in, move, and return to, any position that works for you. Its features include:

- ⤴ Solid, secure mounting
- ⤴ One-handed operation
- ⤴ Low effort, easy access levers to unlock and reposition
- ⤴ Quick and easy tilt adjustment, without tools
- ⤴ Customizable lock positions—24 possibilities per joint
- ⤴ Quick device change out

Take a minute to review the materials and parts included with your Mount'n Mover. We've included a manual to show how to operate and set up the Mount'n Mover. For up-to-date specific attachment instructions, check out our website: www.mountnmover.com. We have an array of informational videos, step-by-step instructions and diagrams on the Support section of our site.

Our friendly staff is available for tech support and questions by email (info@blueskydesigns.us), phone 612-724-7002 or 1-888-724-7002 (US toll-free) and zoom by appointment

Once you've installed the Mount'n Mover, please take time to connect with our community of users on our Facebook site. Our enthusiastic users can also offer helpful hints and suggestions.

Available since 2008, the Mount'n Mover began as a custom design for a teenager who needed to communicate and use her computer at the same time. This practical request produced a rudimentary movable mount which—coupled with Dianne's years of custom rehab engineering experience—became the precursor to the Mount'n Mover product which launched 10 years later.

Our goal is to provide a flexible and customizable solution to make it easier for you to do what you want to do. If you think there's something we could do to make it even better, let us know!

Thank you for choosing the Mount'n Mover,

The BlueSky Team

BlueSky Designs, Inc.

2637 27th Ave South Suite 209 Minneapolis, MN 55406

p: 612.724.7002 toll-free US: 888.724.7002

f: 612.724.7004 toll-free fax US: 888.311.4435

e: info@blueskydesigns.us

www.mountnmover.com

www.blueskydesigns.us

HELPFUL TOOLS:

Mount'n Mover™
by BlueSky Designs

THE MOUNT MENTOR EVAL SHEET

Need help building a mounting system? Please complete the following steps and return to: info@blueskydesigns.us

Step 1. Complete section A
Step 2. Take photos as described in section B
Step 3. Provide post length determined in section C
Step 4. Complete wheelchair frame information in section D

★ We will contact you with a quote. Additional support for installation and use is available via phone, Skype, or email.

A) Lets get started... first we need some information:

Client Person
Organization _____
Name _____
Title _____ Phone # _____
Email _____

Client (Optional)
Home/Initials _____
Age _____ Diagnosis _____

Client Characteristics
How does client access their device?
Direct Select ☐ Switch ☐ Eyegaze/Head Tracker ☐
If direct select:
Light touch ☐ Medium touch ☐ Strong touch ☐
Will the client move it? Y ☐ N ☐
If yes, what arm preference?
Left ☐ Right ☐ Both ☐
Can they even install? Y ☐ N ☐
How does client drive Power Wheelchair?
If applicable:
Hand joystick on: Left ☐ Right ☐
Cris joystick ☐ Head array ☐
Prefer to mount on: Right side ☐ Left side ☐
Is there an existing tray on w/c? Y ☐ N ☐
Preferred Mount(s) www.mountnmover.com

Attach to: (Check all that apply)

☐ Wheelchair (Make/Model) _____
☐ Power _____
☐ Manual _____
With manual w/c does client apply brakes? Y ☐ N ☐
☐ Tilt/Adjustable _____
Do you need to remove both foot rests? Y ☐ N ☐
☐ Stroller _____
☐ Walker/Gait Trainer _____
☐ Bed _____ ★ Include photos
☐ Floor Stand ☐ Table _____
Device / Tray [See website for Device Photo Graph](http://www.mountnmover.com)

☐ SGD or AAC make/model _____
☐ Does Device have QRM/URS bracket? _____
☐ Phone make/model/dimensions _____
☐ Tablet/iPad Make: _____ Model: _____
Dimensions: _____
☐ Rotate portrait to landscape required? _____
☐ Laptop Tray ☐ 12 x 16 Tray _____
Require access to more than one device? Y ☐ N ☐
If yes: ☐ At the same time
☐ Change as needed
☐ Two Mounts: ☐ one post - (double decker)
☐ two posts



1. THE MOUNT MENTOR EVAL SHEET

Mount'n Mover
Order Sheet

Follow these steps to fully specify a Mount'n Mover system.

Client Name _____
Client Type _____
Mount Type _____
Mount to attach _____
Mount to attach _____
Mount to attach _____

Step 1: Choose a Mount'n Mover

Dual Arm
M2-TQ-H * ☐
M2-TQ-L * ☐
M1-TQ-H * ☐
M1-TQ-L * ☐
M0-TQ-H * ☐
M0-TQ-L * ☐

Single Arm
M1-TQ-H * ☐
M1-TQ-L * ☐
M0-TQ-H * ☐
M0-TQ-L * ☐

Tilt'n Turner
M1-TQ-H * ☐
M1-TQ-L * ☐
M0-TQ-H * ☐
M0-TQ-L * ☐

EASY MOVERS

Easy Mover with Quick Connect Receiver (dual and single arm)
EM2-QC-H * ☐
EM2-QC-L * ☐
EM1-QC-H * ☐
EM1-QC-L * ☐

Easy Mover with Tilt Plate (locking tilt plate)
EM2-LTP-H * ☐
EM2-LTP-L * ☐
EM1-LTP-H * ☐
EM1-LTP-L * ☐

Easy Mover with Tilt Plate (non-locking tilt plate)
EM2-TP-H * ☐
EM2-TP-L * ☐
EM1-TP-H * ☐
EM1-TP-L * ☐

Quick Release Plate
EM2-QRP-H * ☐
EM2-QRP-L * ☐
EM1-QRP-H * ☐
EM1-QRP-L * ☐

Tilt Hinge Resistance:
We recommend the High Resistance Hinge for heavier devices (5-10 lbs, 2.3 kg or greater).
The High Resistance Hinge allows device angle adjustment when the tilt drive is engaged. Low Resistance Hinge can be manually locked using the Tilt Lever Lock.

SIMPLE MOUNTS

Simple Mount Large
SM-LG-H * ☐
SM-LG-L * ☐

Simple Mount Small
SM-S-H * ☐
SM-S-L * ☐

Simple Mount with Quick Connect Receiver
SM-QC-H * ☐
SM-QC-L * ☐

Additional Lip Supports
Set of 4
TLA-S-1/2 ☐
TLA-S-1 ☐
TLA-S-1/2 ☐
TLA-S-1 ☐

January 2018 pg. 1 of 5



2. MOUNT'N MOVER ORDER SHEET

Find both of these tools on our website:

www.mountnmover.com

Table of Contents

[Download another Instruction booklet:](http://www.mountnmover.com/products/eval-kits)
www.mountnmover.com/products/eval-kits

5. Wheelchair attachment overview Wheelchair Attachment Plates and Hardware:

- 9. WC-AAP Angle Adjustment Plate
- 10. WC-LAE L-Angled Extension Plate
- 11. WC-AP4 Adapter Plate 4
- 12. WC-AP2 Adapter Plate 2
- 13. WC-AP5 Adapter Plate 5
- 14. WB2 Wheelchair Bracket
- 15. WC-R1B-Set + WC-R7/8B-Set Round Bridge Clamp 1" and 7/8"
- 16. WC-TN T-Nut
- 17. WC-COVED-1" SET 1" Coved Spacers with hardware
- 18. WC-COLLAR-1" SET 1" Collar Clamps with hardware

Device Plates:

- 21. Device Plate Graph Not all Device Plates are included in this Eval Kit. Call us!
- 23. DP-PRC5 For PRC devices. Can also use DP-QCR and Existing PRC Mounting Bracket
- 24. Blank Page
- 25. DP-Multi1 VESA, Smartbox, Skyle, Lightbox, Control Bionics
- 26. DP-QCR Attaches to most PRC and Tobii Devices
- 27,28,29. DP-T5 Attaches to Tobii I-13 and I-16
- 30. DP-EXT To offset for IR on Tobii I-13 and I-16. Also for use on larger devices to clear the hoop
- 31,32. DP-UR Universal Rotator (switch from portrait to landscape) or (correct tilt for eyegaze)
- 33. DP-QCP Connects to DP-QCR and to Rehadapt UDS

Mounts and Accessories:

- 36, 37. EM2-LTP-H Easy Mover Dual Arm with high torque hinge
- 38,39. M2-TQ-H Dual Arm Mount'n Mover
- 40. P18, P12 Posts (other sizes/custom are available)
- 41. TC Table Clamp
- 42. WB2-EXT Post Clamp Extension Kit
- 43. Chose and Accessorize
- 44. TR-iTab or TR-LG Trays (Eval Kit includes a Laptop Tray and your choice of a Large Tablet Tray or an iTab Tray)
- 45,46,47,48,49. Link Cube Configurations, Multi Mount Systems, Eval Sheet, Etc

 **Please take pictures of your final set up for ease of ordering!**

Wheelchair Attachment Overview

* All plates are considered 'multi-use plates' and can be configured, combined, and used in a variety of ways.

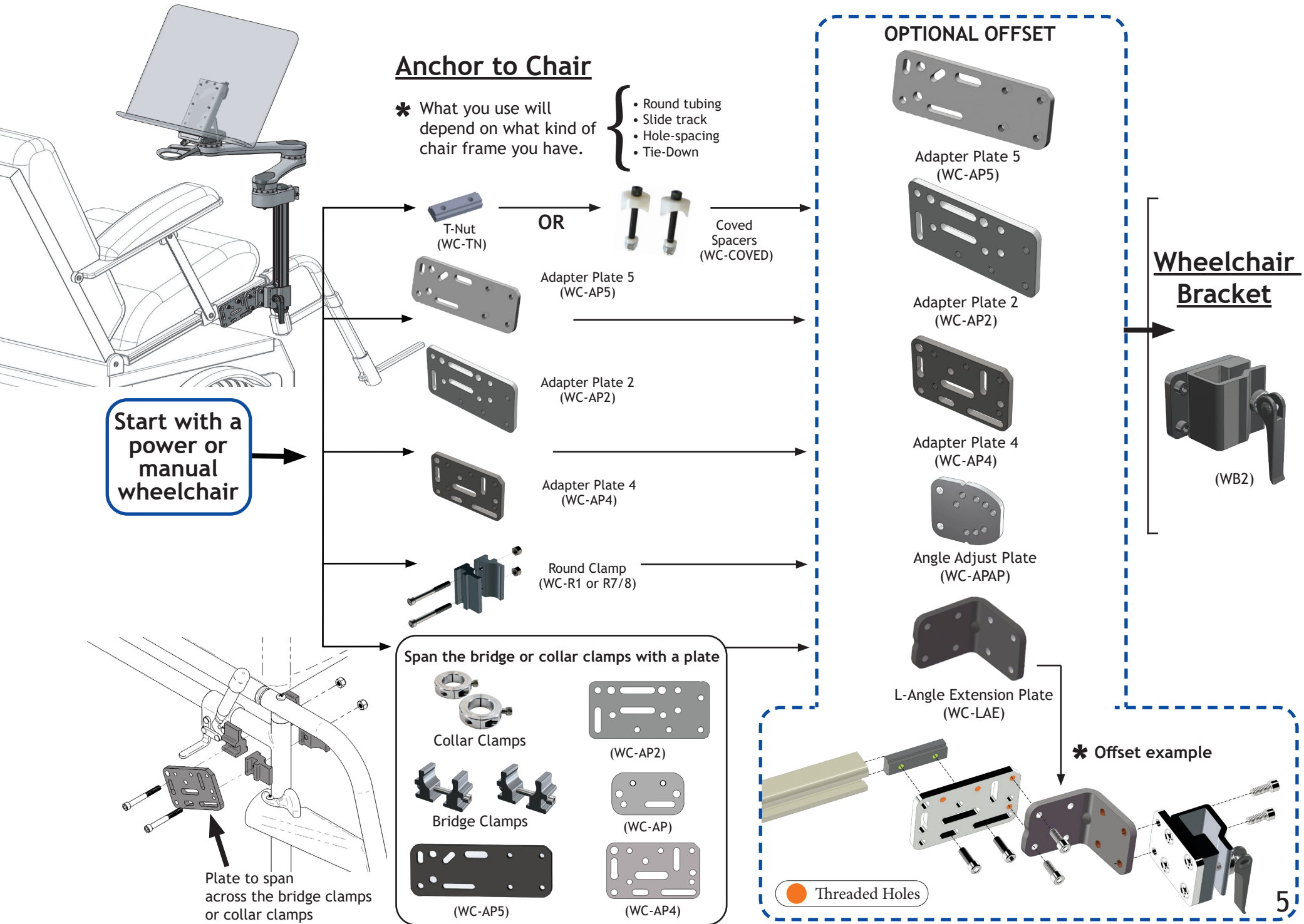

Wheelchair Attachment Plates and Hardware



WARNING!

Never attach two plates via threaded hole to threaded hole!
This damages the threads and the connection can loosen!

Plate to Plate Attachment Options

- Non-threaded hole to threaded hole = Good
- Non-threaded hole to non-threaded hole with nut = Good
- **Threaded hole to threaded hole = Not good**
(will damage threads!)

Hole Pairing Options

- Attaching with two holes = **BEST**
- Hole and slot (horizontal or vertical) = Good
- Slot and slot (both horizontal) = Ok
- Two vertical slots = **NOT GOOD!** (could slip or wobble!)

Angle Adjustment Plate (WC-AAP)

Scale 1 : 1

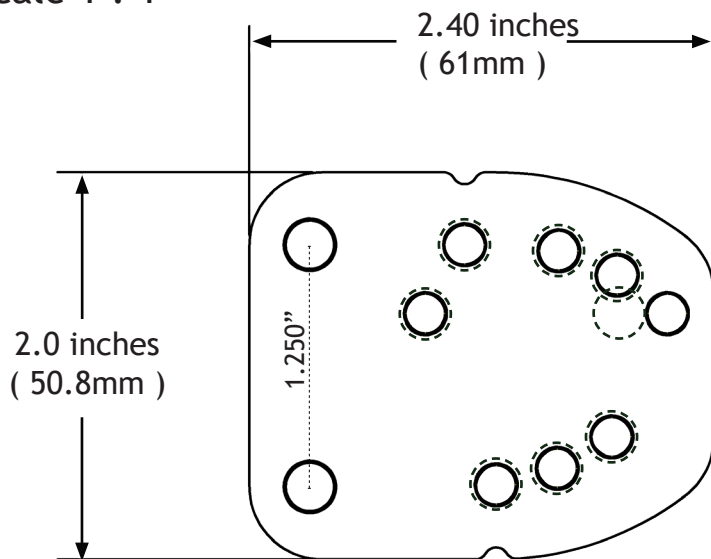

Plate to Plate Attachment Options

- Non-threaded hole to threaded hole = Good
- Non-threaded hole to non-threaded hole with nut = Good
- Threaded hole to threaded hole = Not good
(will damage threads!)

Set Includes:

- (1) Angle Adjustment Plate
- (2) 1/4-28 x 1/2" Socket head cap screws

1/4-28 Threaded Holes (Qty = 8)

Non-threaded
holes (Qty = 2)

WC-AAP

Angles available with the Angle Adjust Plate (AAP)
(Tilts to accommodate WB2 at horizontal level)

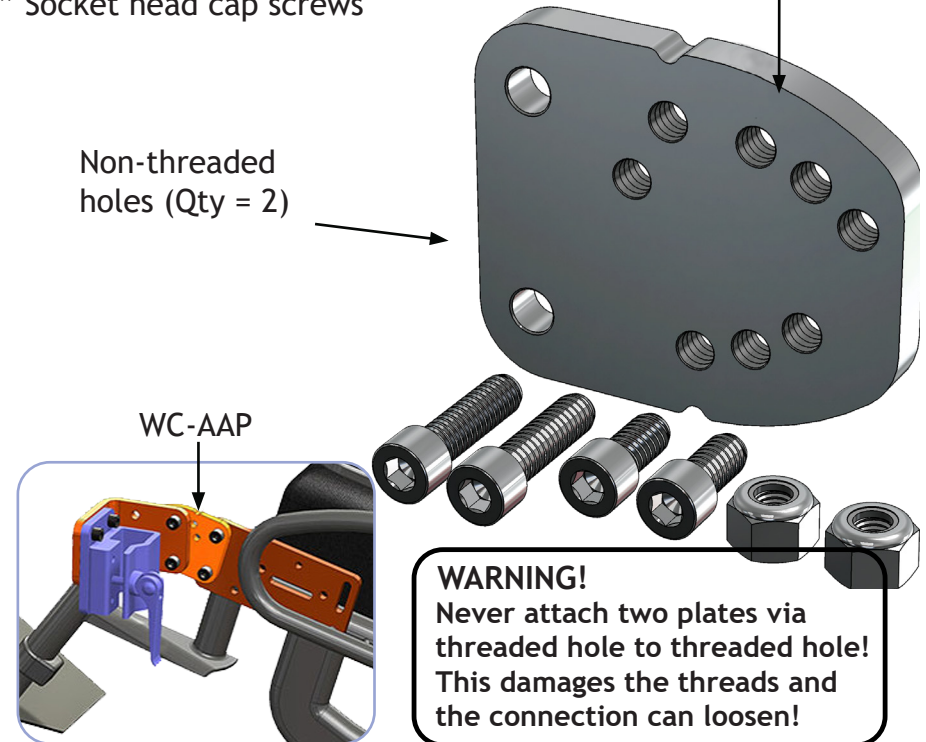
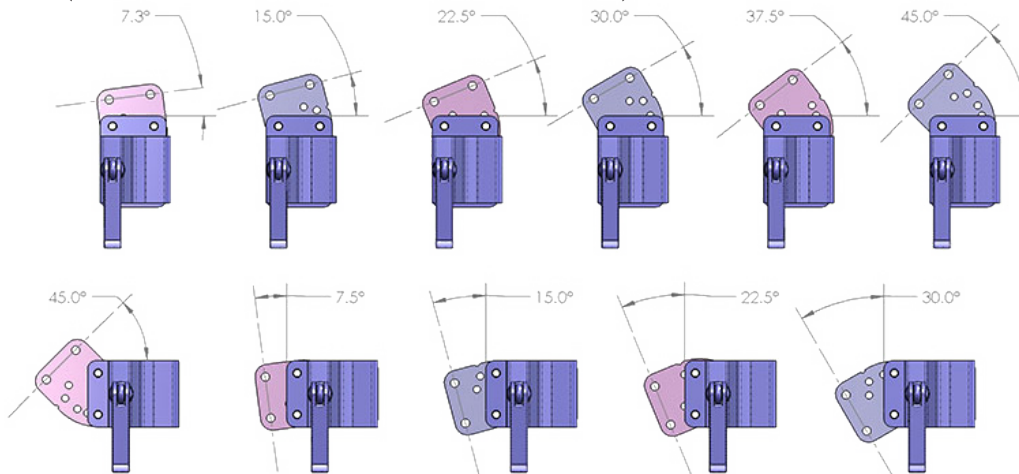

Mount'n Mover™
by BlueSky Designs

Product: WC-AAP, Angle Adjustment Plate
Weight: 4.4 oz. (0.12 kg)

L-Angled Extension Plate (WC-LAE)

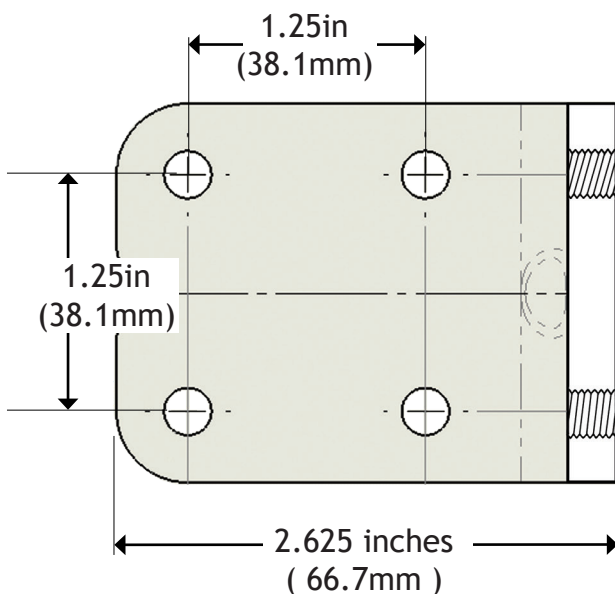
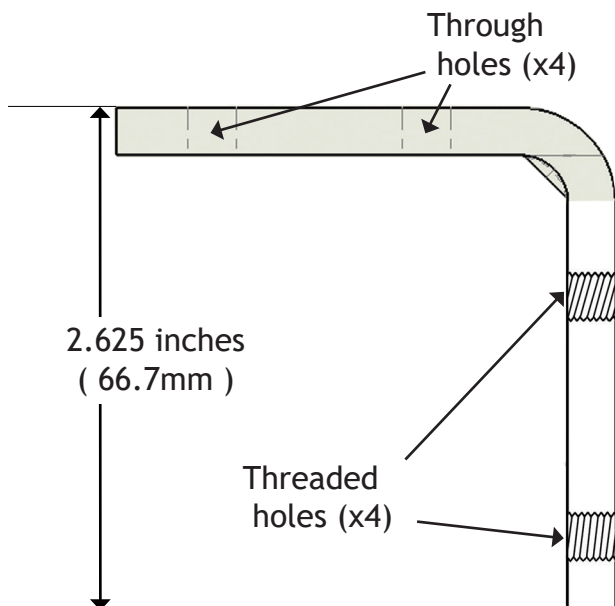

Mount to track under armrest on the F5 standing. This way the mount travels for use either sitting or standing.



Mount to dual track just below the seat. Use the hardware "Permobil Unitrack" This hardware is included with WC-AP4 or AP2 adapter plate.

WC-LAE PLATE being used to offset the solid wheelchair bracket (WB2) out from chair.

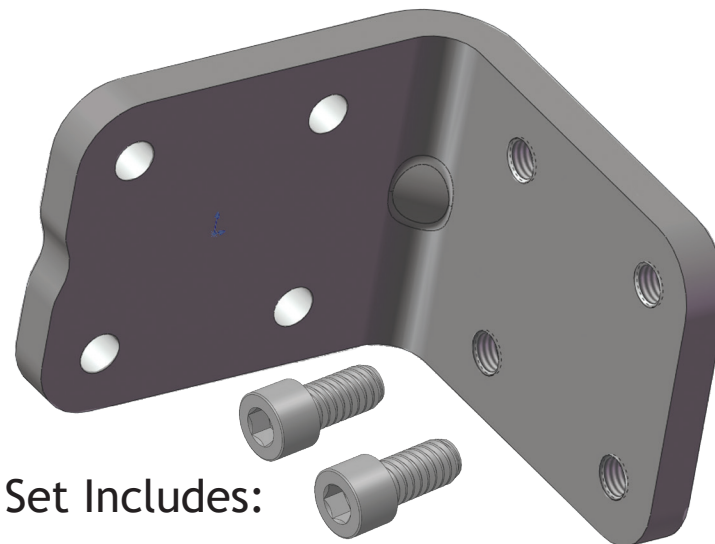
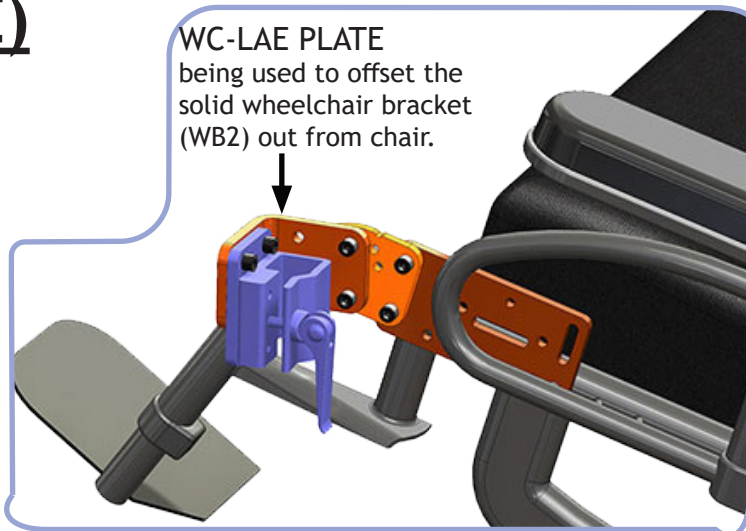

Set Includes:

One L-Angled Extension Plate
Two 1/4-28 x 1/2" Socket head cap screws

- * **Always** attach [through hole] to [threaded hole]. Minimum of two bolts to attach plate
- * **Never** attach [threaded hole] to [threaded hole]. Can damage threads!

Adapter Plate 4 (WC-AP4)

Scale 1 : 1

1/4-28 threaded Hole (Qty = 5)

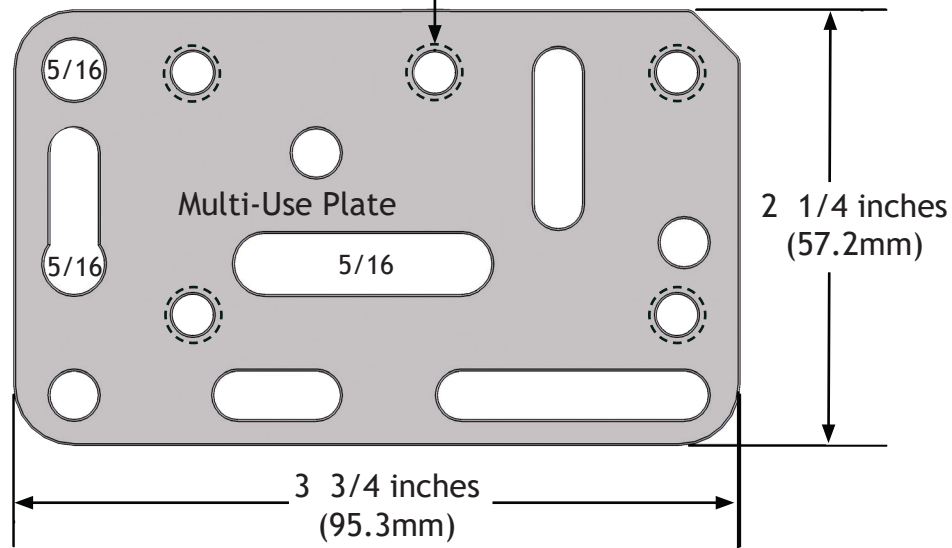
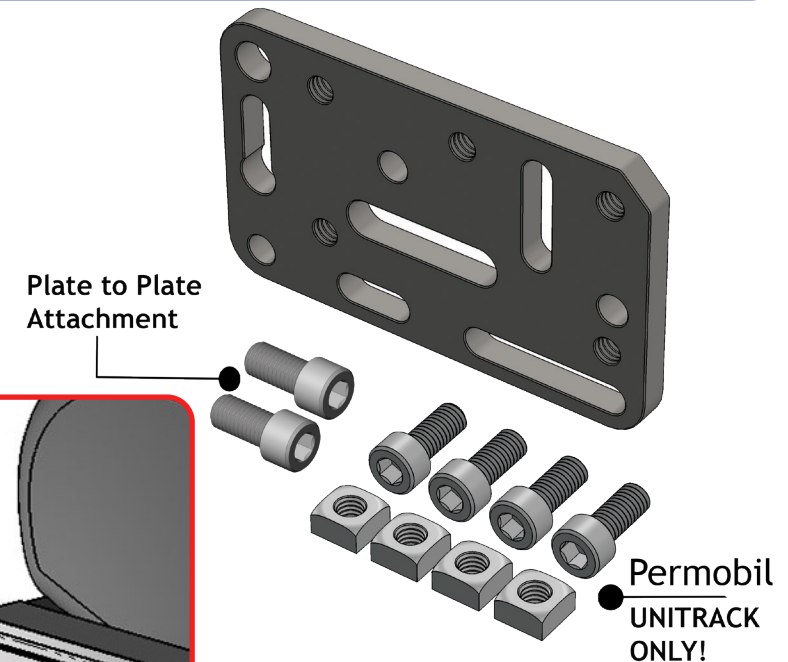

Plate to Plate Attachment Options

- Non-threaded hole to threaded hole = Good
- Non-threaded hole to non-threaded hole with nut = Good
- Threaded hole to threaded hole = **Not good**
(will damage threads!)

Hole Pairing Options

- Two holes = **BEST**
- Hole and slot (horizontal or vertical) = Good
- Slot and slot (both horizontal) = Good
- Two vertical slots = **NOT GOOD!** (could slip!)



Set Includes:

(1) Adapter Plate 4 (WC-AP4)

Hardware - Plate to Plate Attachment

(2) 1/4-28 x 1/2" Socket head cap screws

Hardware - Unitrack:

(4) M6-1 x 14 Socket head cap screws

(4) M6-1 x 10 Square nut

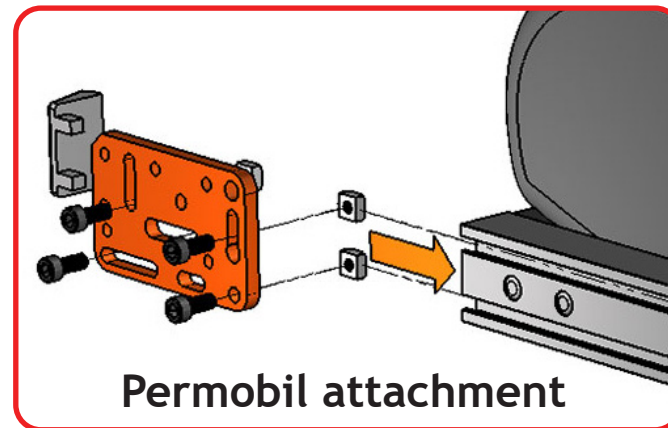

Adapter Plate 2 (WC-AP2)

SCALE 1:1

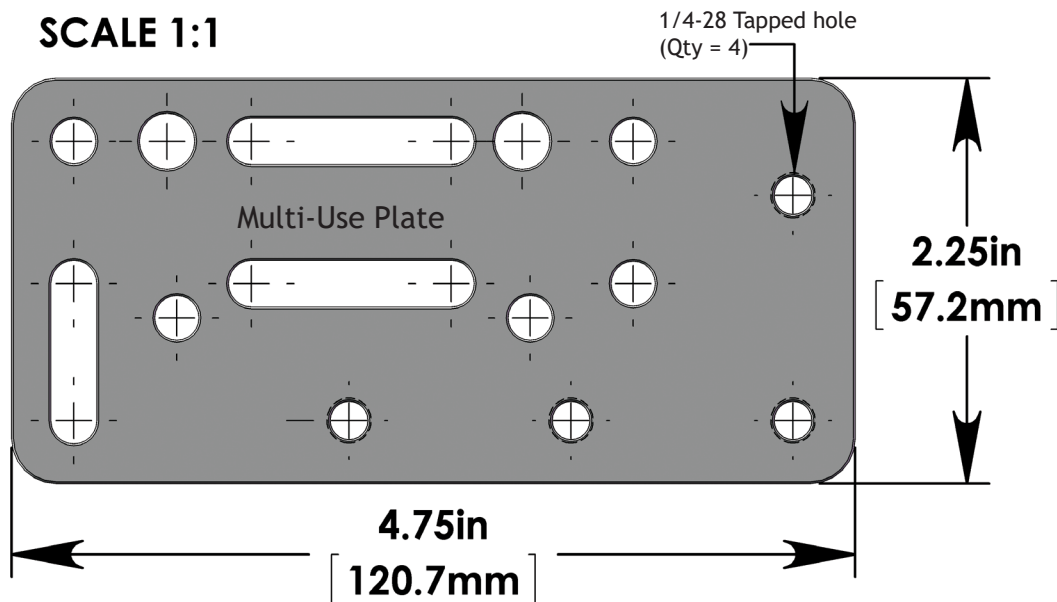

Plate to Plate Attachment Options

- Non-threaded hole to threaded hole = Good
- Non-threaded hole to non-threaded hole with nut = Good
- Threaded hole to threaded hole = Not good (will damage threads!)

Hole Pairing Options

- Two holes = BEST
- Hole and slot (horizontal or vertical) = Good
- Slot and slot (both horizontal) = Good
- Two vertical slots = NOT GOOD! (could slip!)

Set Includes:

(1) Adapter Plate 2 (WC-AP2)

Hardware - Plate to Plate Attachment

(2) 1/4-28 x 1/2" Socket head cap screws

Hardware - Unitrack:

(4) M6-1 x 14 Socket head cap screws

(4) M6-1 x 10 Square nut

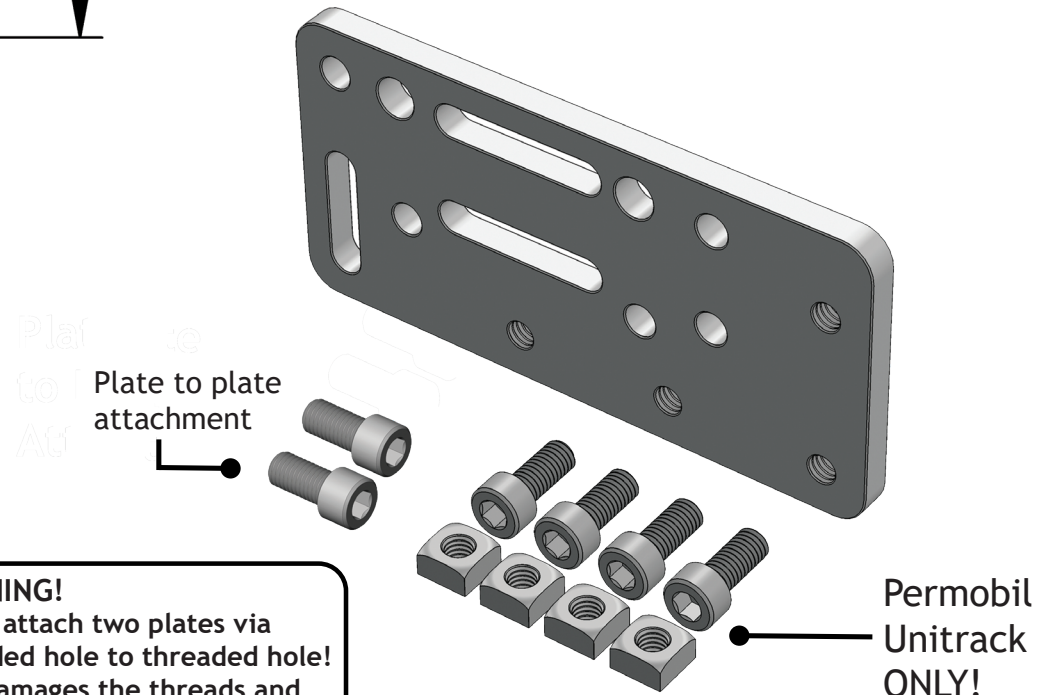

WARNING!

Never attach two plates via threaded hole to threaded hole! This damages the threads and the connection can loosen!

Mount'n Mover™
by BlueSky Designs

Product: WC-AP2, Adapter Plate 2
Weight: 10.0 oz. (0.28 kg)

Adapter Plate 5 (WC-AP5)

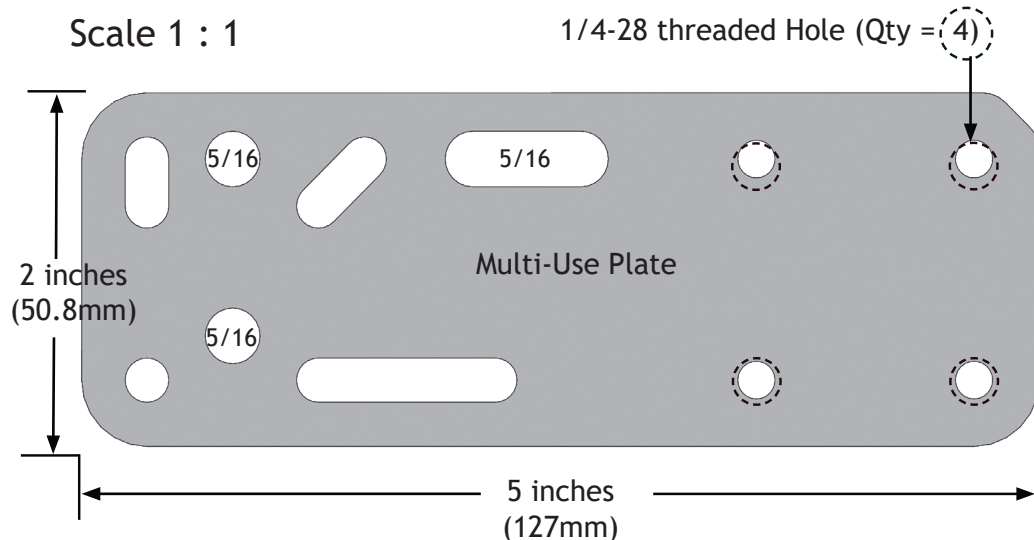

Plate to Plate Attachment Options

- Non-threaded hole to threaded hole = Good
- Non-threaded hole to non-threaded hole with nut = Good
- **Threaded hole to threaded hole = Not good**
(will damage threads!)

Hole Pairing Options

- Attaching with two holes = **BEST**
- Hole and slot (horizontal or vertical) = Good
- Slot and slot (both horizontal) = Good
- Two vertical slots = **NOT GOOD!** (could slip!)

Set Includes:

(1) Adapter Plate 5 (WC-AP5)

Hardware - Plate to Plate Attachment

(2) 1/4-28 x 1/2" Socket head cap screws

Hardware - Unitrack:

(4) M6-1 x 14 Socket head cap screws

(4) M6-1 x 10 Square nut



WARNING!

Never attach two plates via threaded hole to threaded hole!
This damages the threads and the connection can loosen!

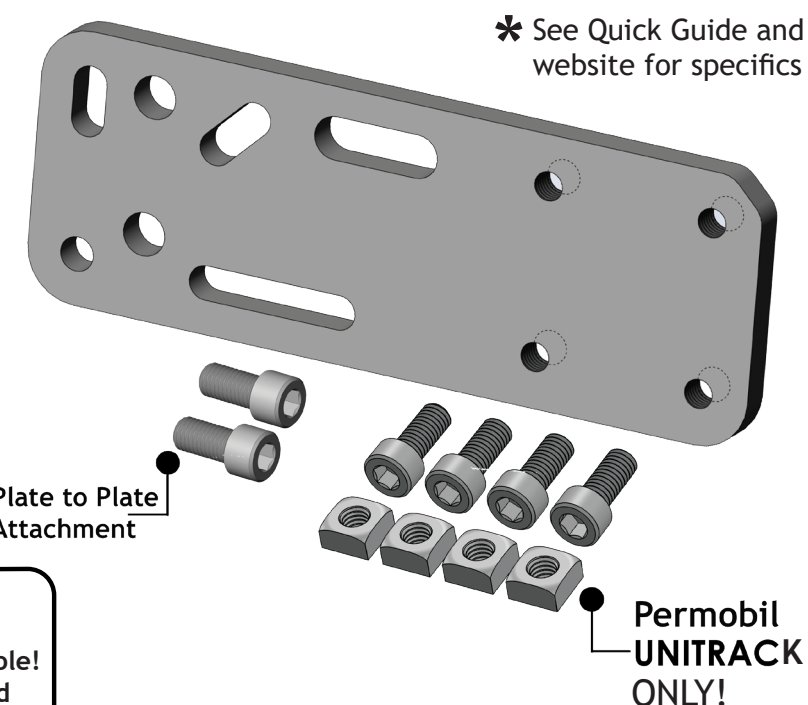

Wheelchair Bracket (WB2)

Scale 1 : 1

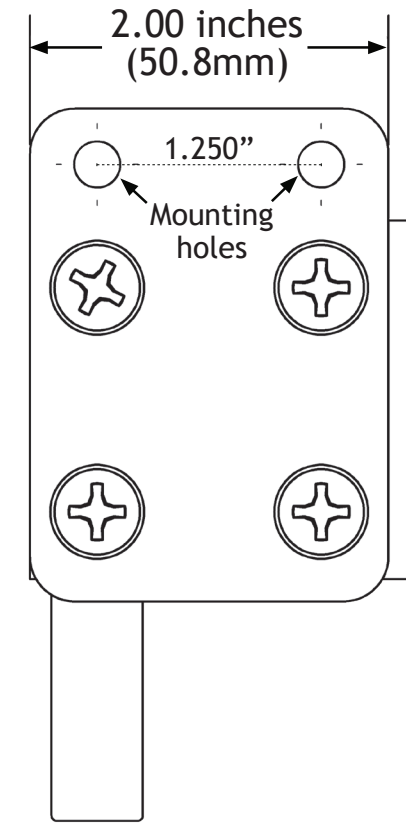
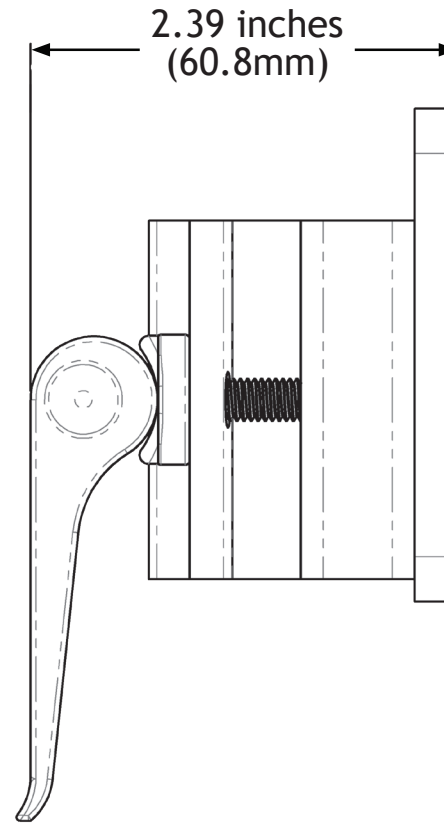
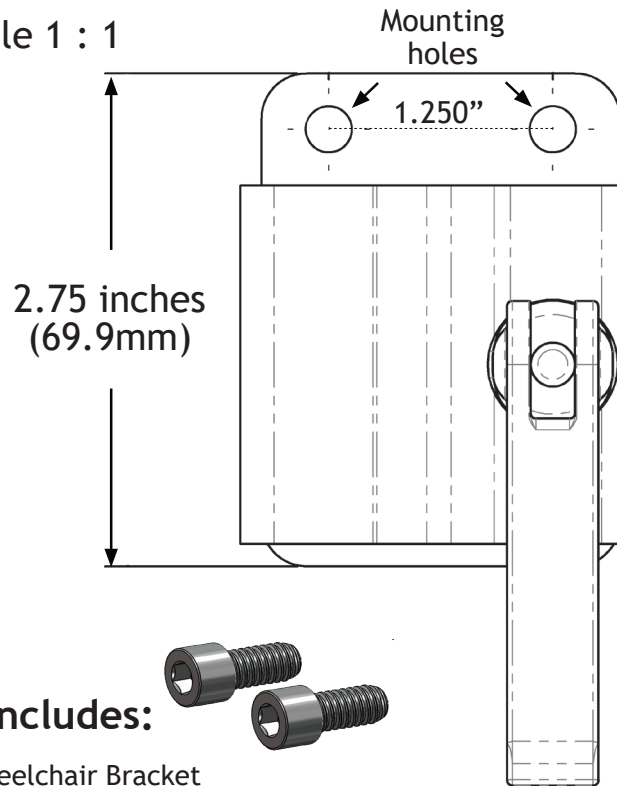

Set Includes:

- (1) Wheelchair Bracket
- (2) 1/4-28 X 0.5" Socket Head Screws

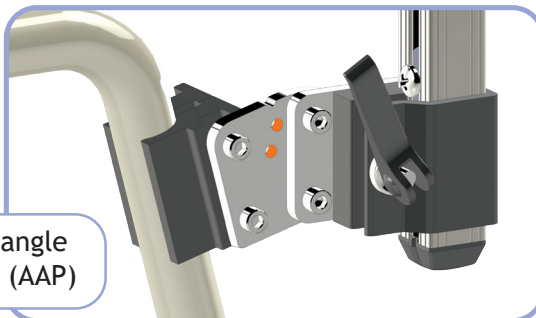

WB2 attached to angle adjustment plate (AAP)

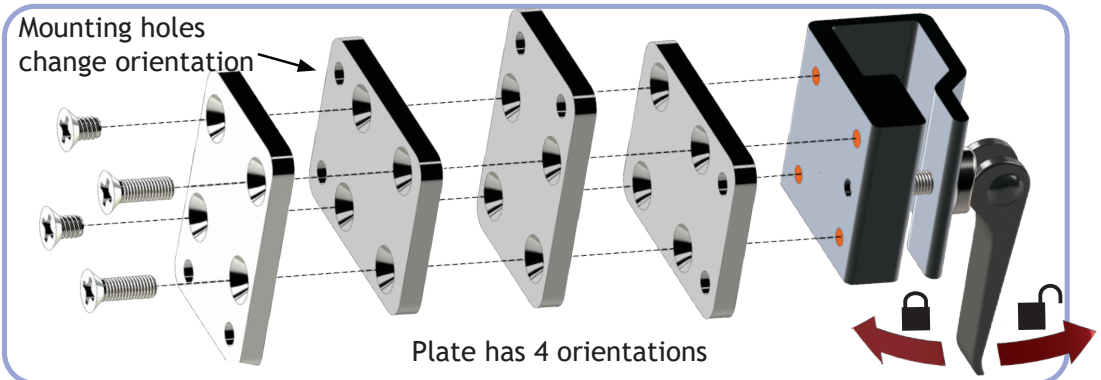

Round Bridge Clamp (WC-R1B-set) or (WC-R7/8B-set)

Scale 1 : 1

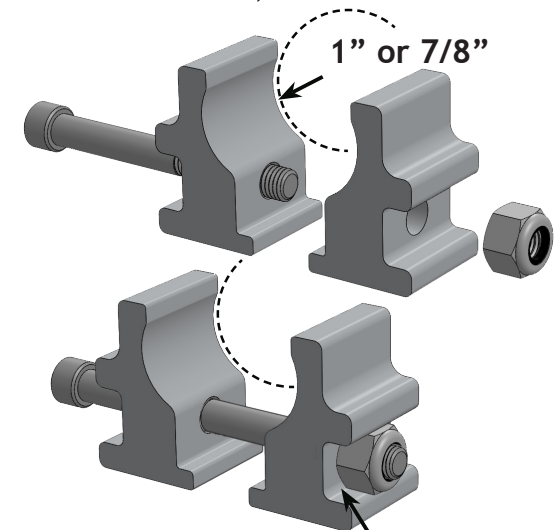
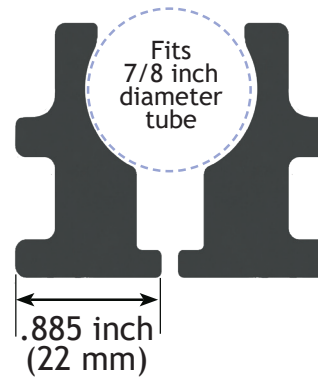
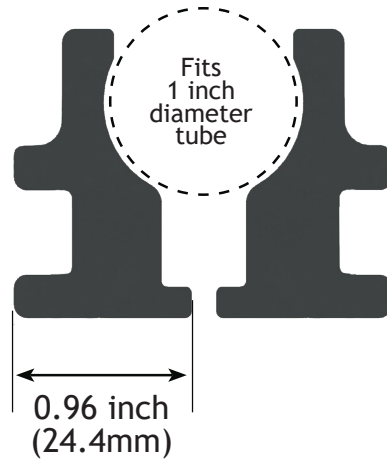
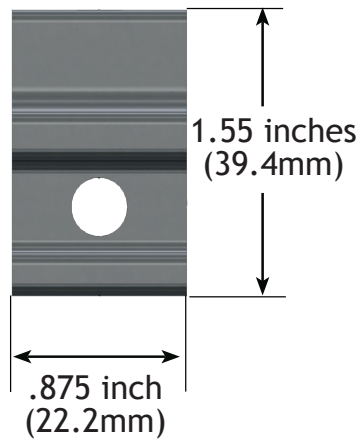

Set Includes:

- (4) Clamps [1 set -1"] or [1 set-7/8"]
- (2) 1/4-28 x 2 1/4" Socket Head Cap Screw
- (2) 1/4-28 Lock-nut

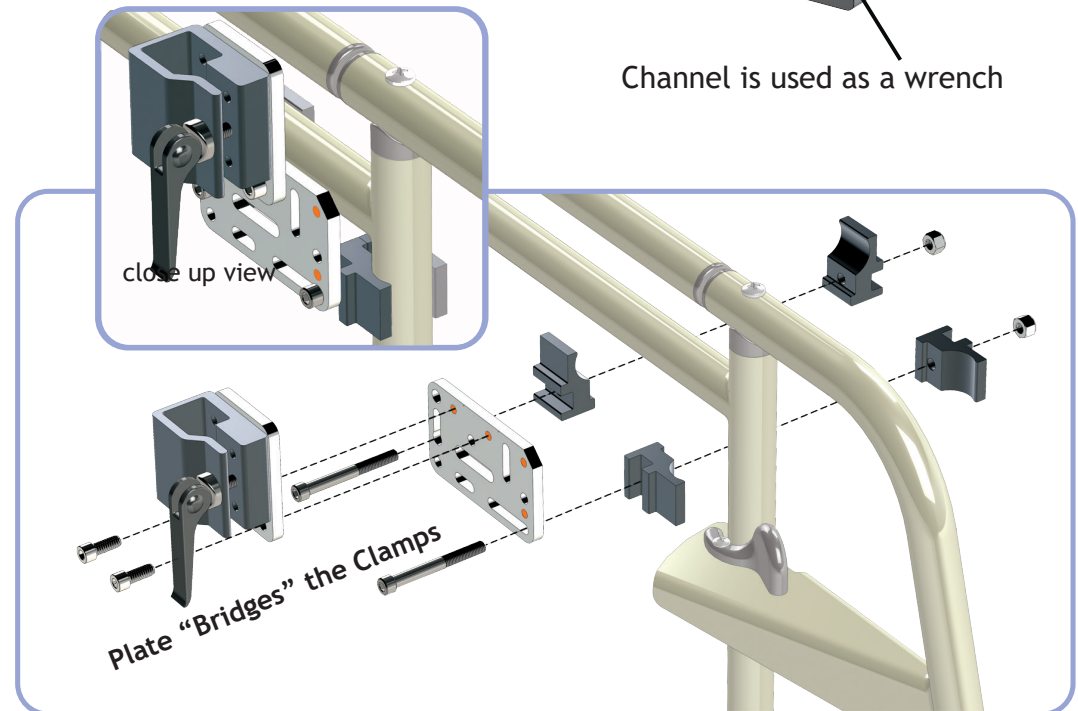
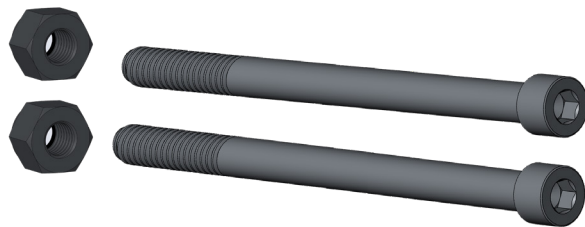

Mount'n Mover™
by BlueSky Designs

Product: WC-R1"B or WC-R7/8"B, Round Bridge Clamp
Weight: 2.5 oz. (0.07 kg)

T-Nut (WC-TN) (for use with slide track)

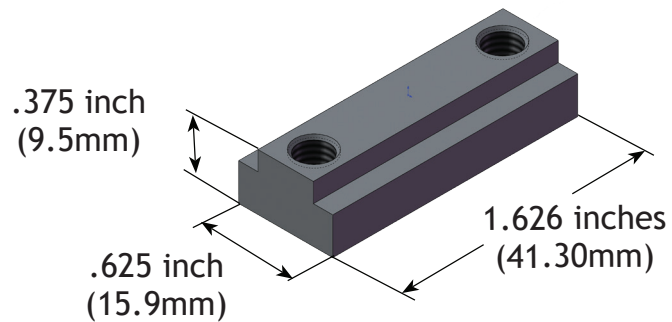

Set Includes:

- (1) T-nut
- (2) 1/4-28 x 5/8" Socket Head Cap Screw

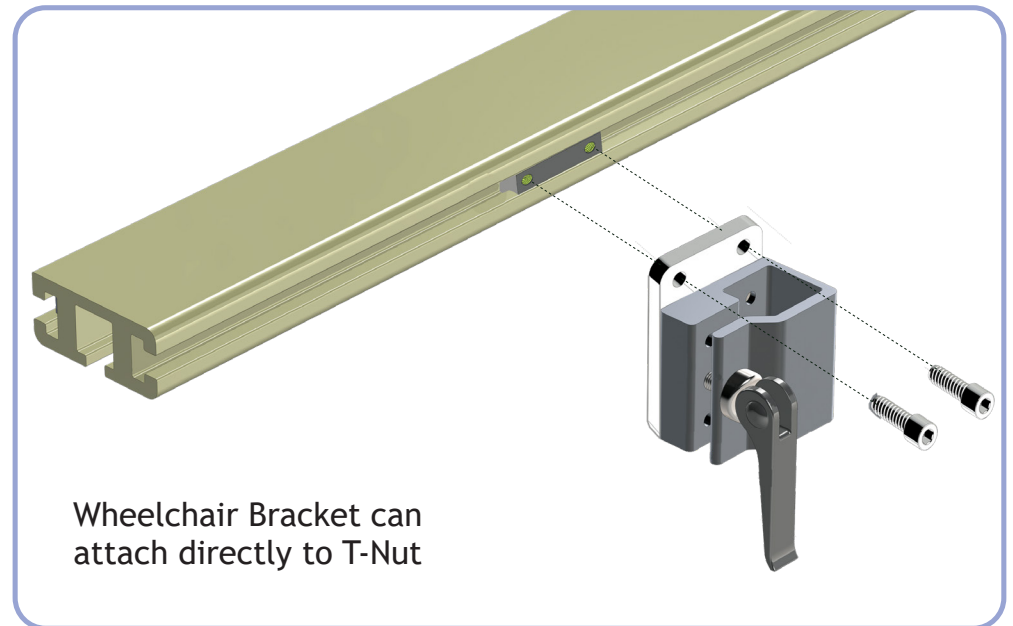
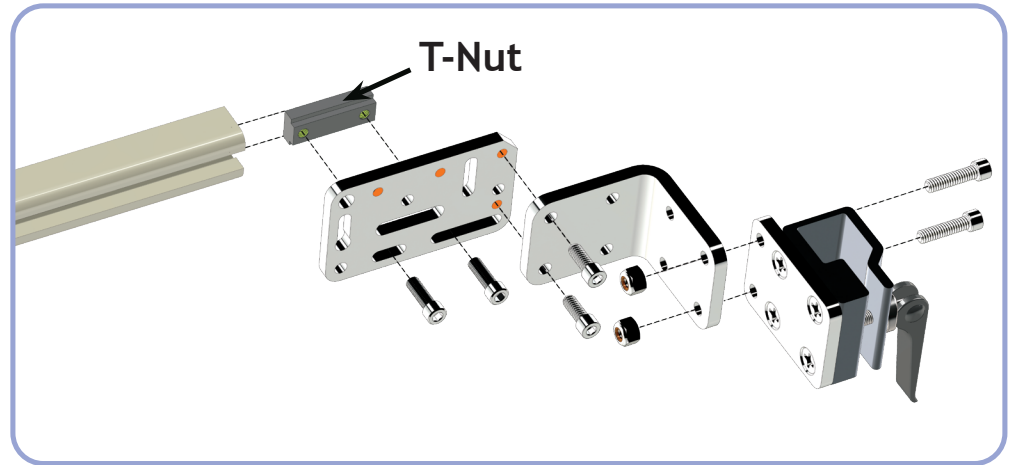

COVED SPACERS 1" (7/8 inch coved spacers also available)



Included:

- Coved Spacers (1 inch) (x2)
- Nylon Washers (x2)
- Bolts M6-50 (x2)
- Lock Nuts M6 (x2)

The coved spacers provide a flat surface for the adapter plate to attach to the round tubing.

USING THE COVED SPACERS TO ATTACH THE WC ADAPTER PLATE

The size of the coved spacers (1 inch or 7/8 inch) depends on the size of the tube on the wheelchair.

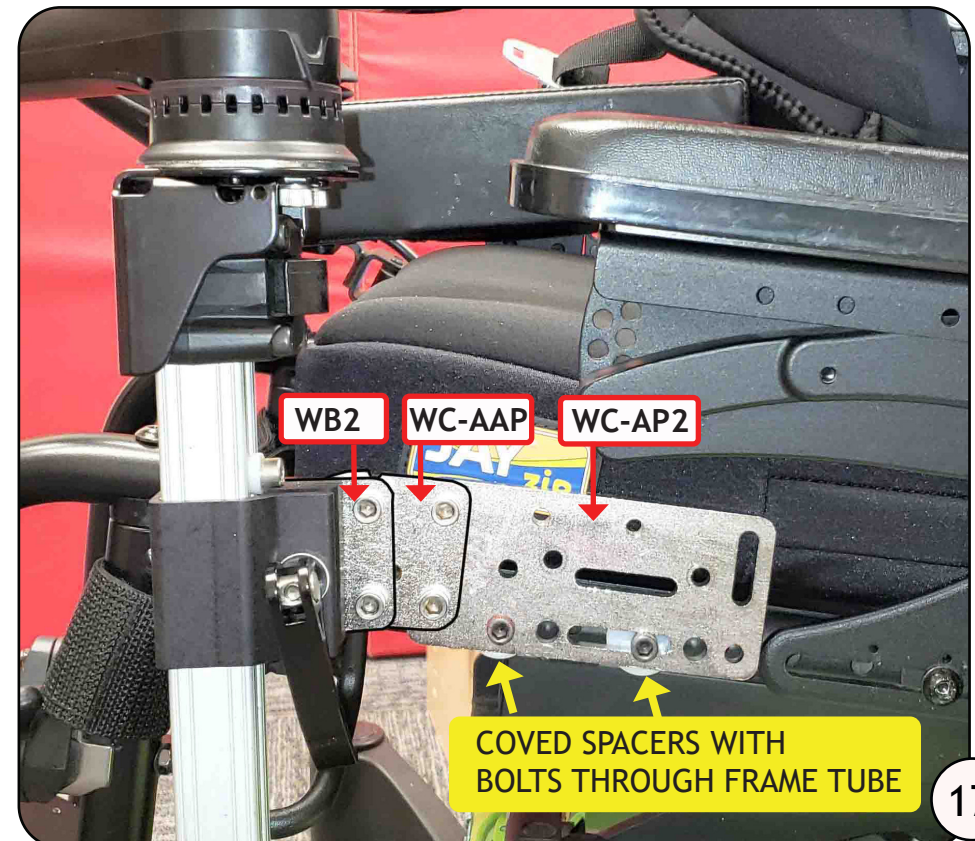
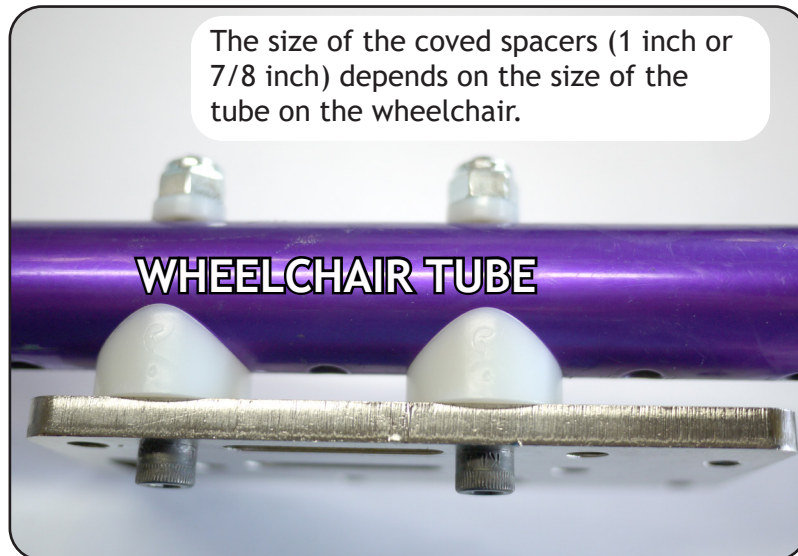

Collar Clamps (Set of two 1" clamps and a set of two 1.125 inch clamps)

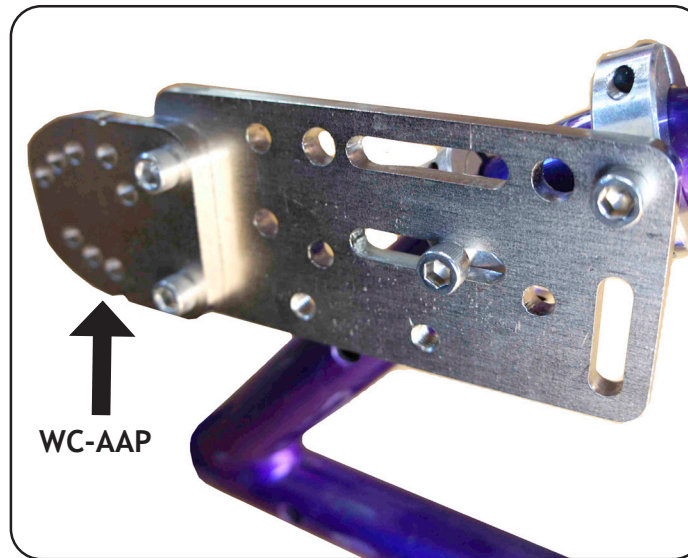
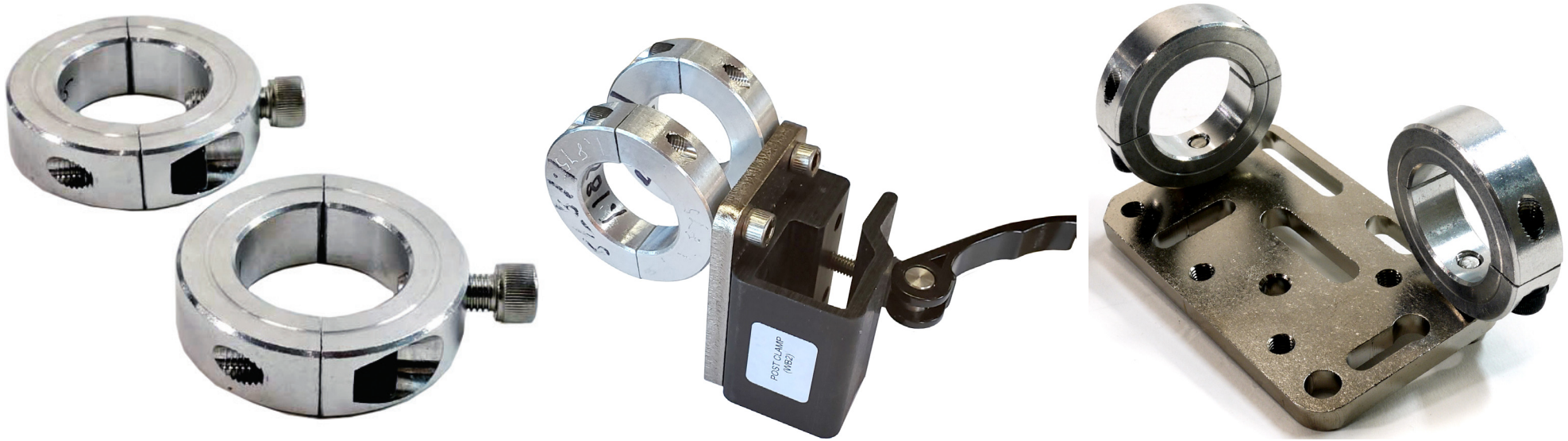

Mounting on a curve will usually require an WC-AAP (angle adjust) plate to correct the angle to vertical for the WB2 (wheelchair bracket). This will allow the post to be vertical.

Collar clamps come in many sizes. If you need a different size we will need to know the circumference of the tube you will be attaching to.

Device Plates

NOTE: Not all device plates are included in this Eval Kit.
See next page for “Device Plate Graph” and a list of devices

Device Plate Graph

QRP - Quick Release Plate
QCR - Quick Connect Receiver

Find the attachment plate for your device				
MAKE	MODEL	PLATE		
		For devices not shown - contact us		
		QRP	QCR	
Tobii Dynavox	TD Pilot			Tobii Plate
	I-110	DP-T4		DP-T4 and QCP
	Navio			Tobii Plate
	I-13, I-16			DP-T5
Prentke Romich Co.	Accent 800, 1000	DP-PRC5		PRC Plate
	Accent 1400	DP-PRC5		DP-QCP-AC14
Salttillo	NOVA chat 8, 10, Via Pro, Via Mini			PRC Plate
	Expression			
Lincare	(Tray TR-LG) or Lincare Plate			
Inclusive TLC	Eyetuitive for iPad or Windows			DP-QCP
Control Bionics	GridPad Trilogy			C.B. Plate
Forbes	Winslate 12, 11, ProSlate 8, 10, 13			Forbes Plate
	Zuvo 12, Wego 13A			DP-QCP-TTMT (and Spacer)
	Talk Pad Wego 8 + 10, Grid Pad 10, 13, 16,			TTMT Plate
EYEGAZE Inc	Eyegaze Edge			EyeGaze Plate
Eyeteach	EyeOn Elite, EyeOn Go			EyeTech Plate
Smartbox	Grid Pad 13, 16,			Smartbox Plate
	Grid Pad 10S, Talk Pad 8, 10, Grid Pad Go			Smartbox Plate
APH for Blind	Lightbox	DP-MULTI1		DP-MULTI1 plus DP-QCP
Jabbla	Vibe 10 + 12			DP-QCP-VIBE
	Tellus 6 and i6			Tellus Plate
	Allora 3			
RM Speech	Nuvo, Inspire, EyeOn	DP-MULTI1		DP-MULTI1 plus DP-QCP
Others	VESA spacing (50,75,100mm)	DP-MULTI1		DP-MULTI1 plus DP-QCP
iPad/Tablets	Fits standard iPads / Tablets (11 x 8 inch maximum)	TR-iTAB		
Large Tablets	iPad Pro 12.9, Surface, Surface Pro (13.5 x 9.5 maximum)	TR-LG Tablet Tray		
Small Laptops	Lingraphica All Talk, Small Laptops (13 x 9 inch maximum)	TR-Small Laptop Tray		
Rehadapt	DP-QCR and DP-QCP are Rehadapt compatible			

DP-PRC5

Attaches to: PRC ACCENT 800, 1000, and 1400

Device plate
to device



6/32 x 3/8" Flat Head (x4)
Screw A

Quick release
plate (QRP) to
device plate

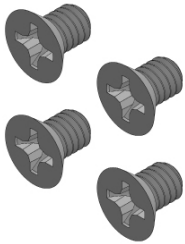

8-32 x 1/4" (x4)
Screw T

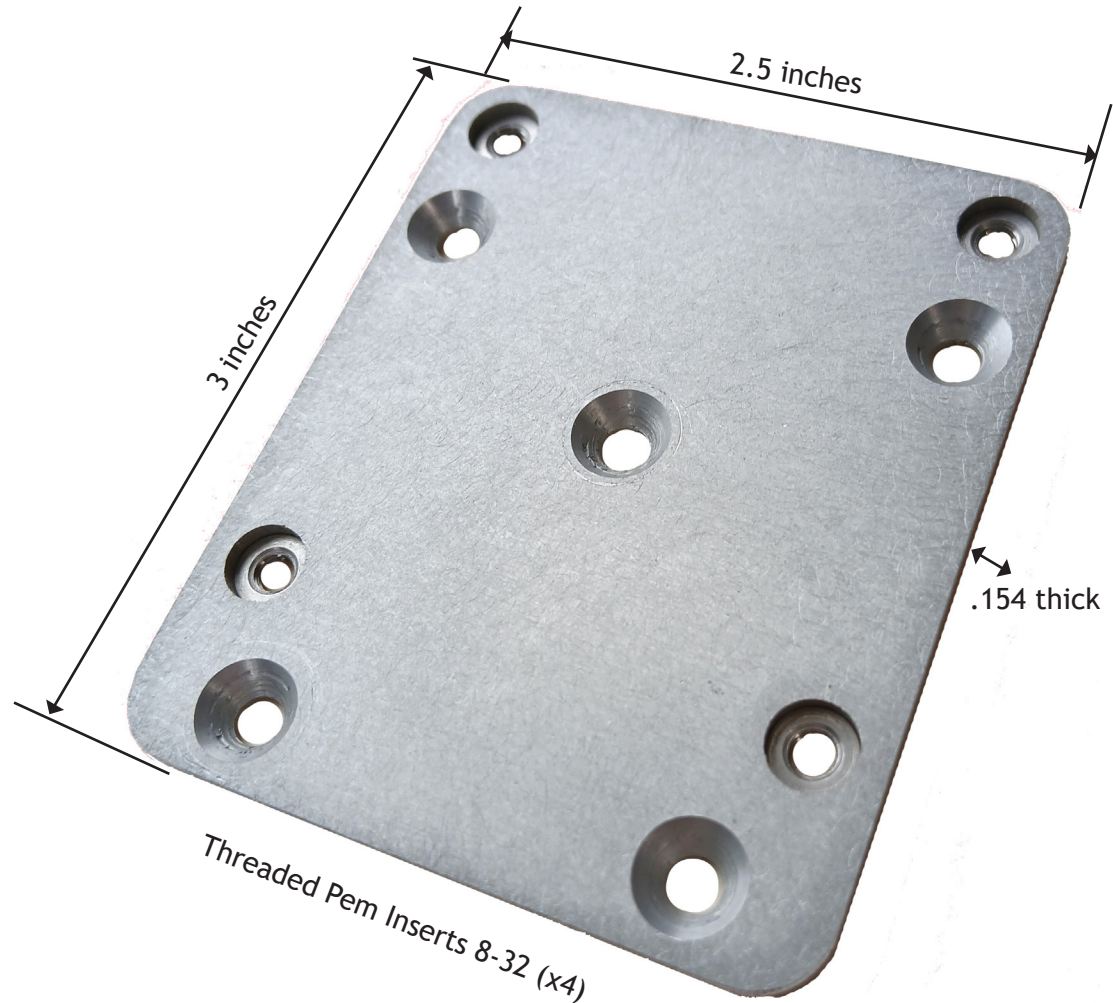

DP-Multi1

Attaches to: VESA (50,75,100mm) Control Bionics, Skyle, Lightbox

- 100 VESA use screw **MMM**



(Screw **MMM** x4)

M4-.7 x 10mm length

- 50 and 75mm VESA



(Screw **PP** x4)

M4-.7 x 10mm length



(x4)
8-32 x 1/4"

Quick release
plate (QRP) to
device plate

VESA hole spacing

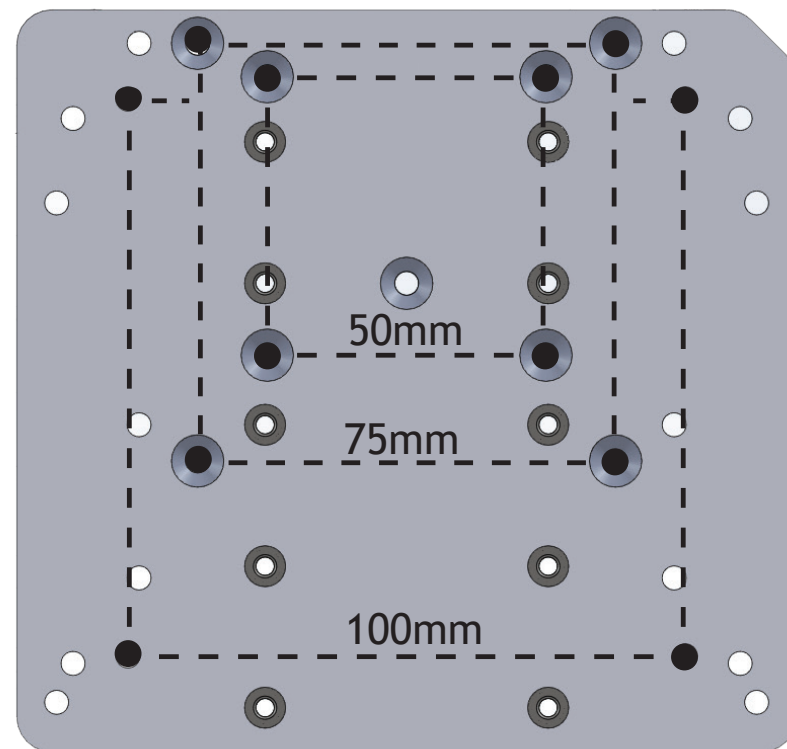

Control Bionics: M4 x 10 (x4) Screw PP

Lightbox: 8-32 x 5/8" (x4) Screw B

Skyle: VESA 75 hole spacing on back of Skyle screw M4 x 8mm(x4). Use 8-32 x 1-3/4"(x4) with 2x2 spacer (not included with EVAL KIT)

Use four M4 x 8mm to attach the Multi Plate to the back of the Skyle...VESA 75

Use four 1-3/4" screws attach the Quick Release Plate-through the 2x2 spacer and into the Multi1 plate.

Quick Connect Receiver (QCR)

Included Hardware:

QRP to DP-QCR



(X4) 8-32 x 1/2" Screws

SALTILLO OFFSET
HARDWARE

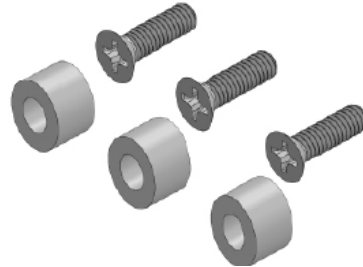

(X3) 6-32 x 1/2" Screws
(X3) 3/16" Nylon Spacers



Attaching the Quick Connect Receiver (QCR) to the Quick Release Plate (QRP)

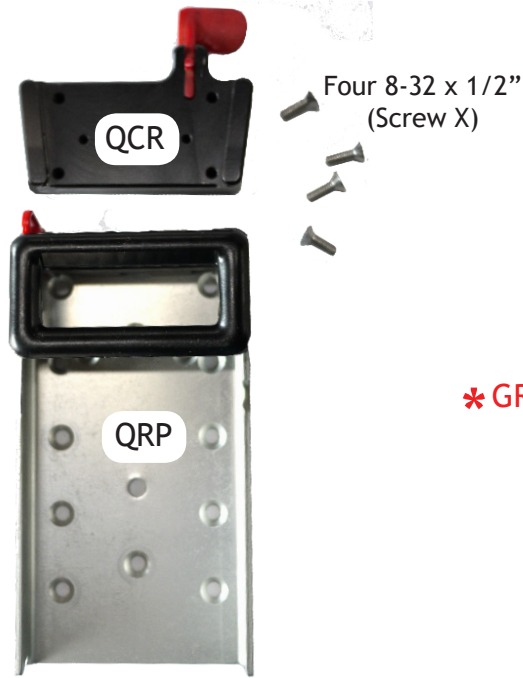

- ① Quick Connect Receiver (QCR) and the Quick Release Plate (QRP) and hardware four screw X.

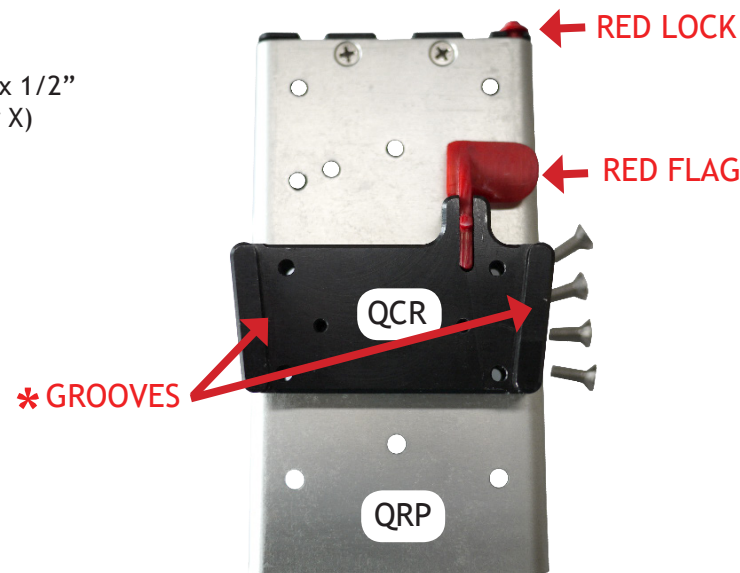

- ② Line up four holes in the QCR with corresponding holes in the QRP. * Note the grooves in the QCR are facing out. The red lock on the QRP and the red flag on the QCR are facing up.

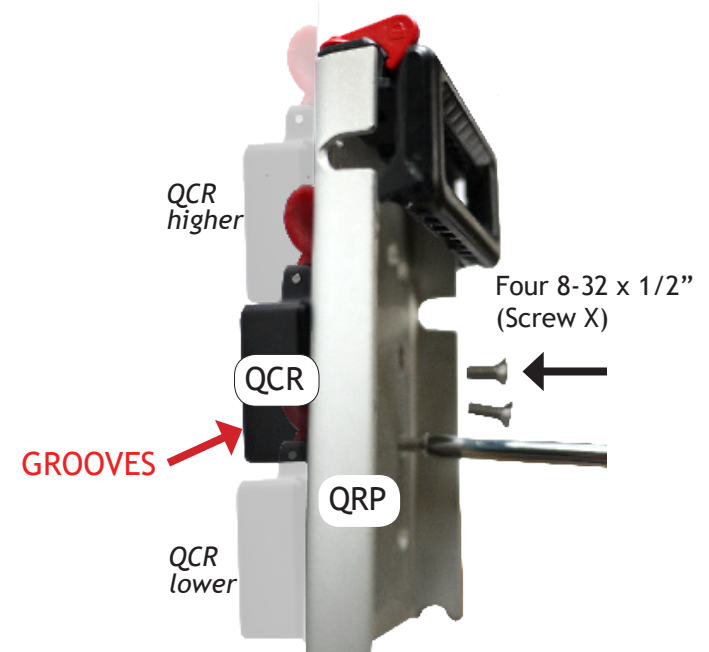

- ③ Feed the four 8-32 x 1/2" screws through the inside of the QRP and into the back of the QCR. The hole spacing in the QRP allows adjustment higher or lower depending on preference

DP-T5 Attaching the Tobii I-13 or I-16 to a Mount'n Mover

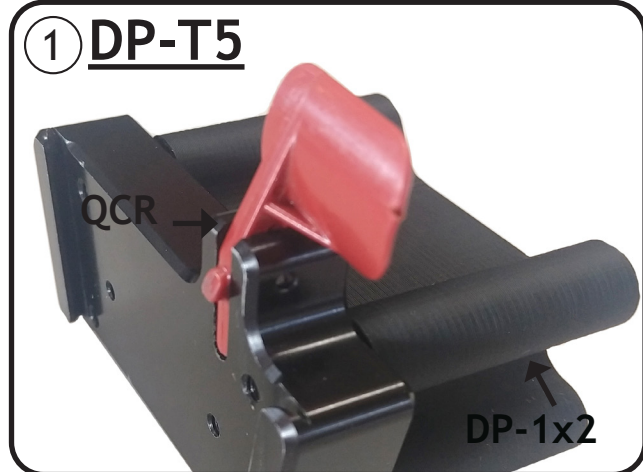

The DP-T5 consists of the Quick Connect Receiver (QCR), the DP-1x2, and four 8-32 x 2" screws

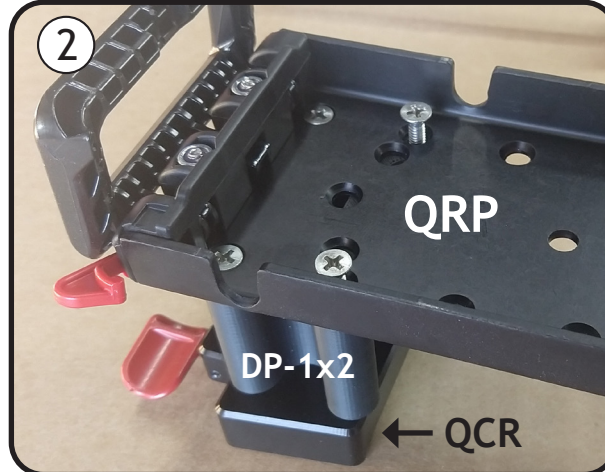

The four screws go through the Quick Release Plate (QRP), through the DP-1x2 and into the Quick connect receiver (QCR)

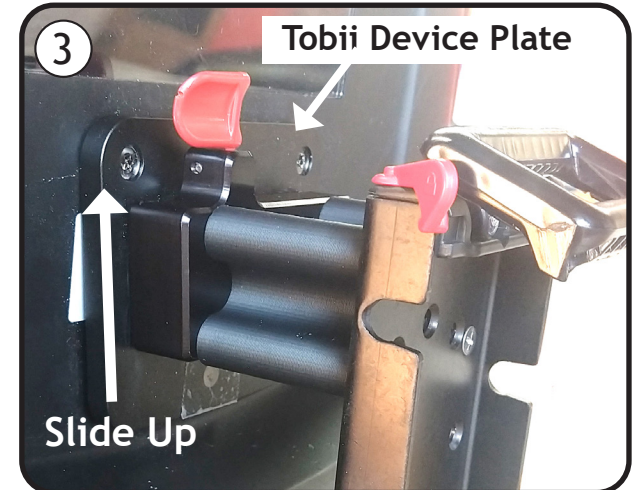

Slide the DP-T5 onto the connecting grooves on the Tobii device plate until it "clicks" in place.



DP-T5 Attaching the Quick Release Plate (QRP) to the Tilt Plate

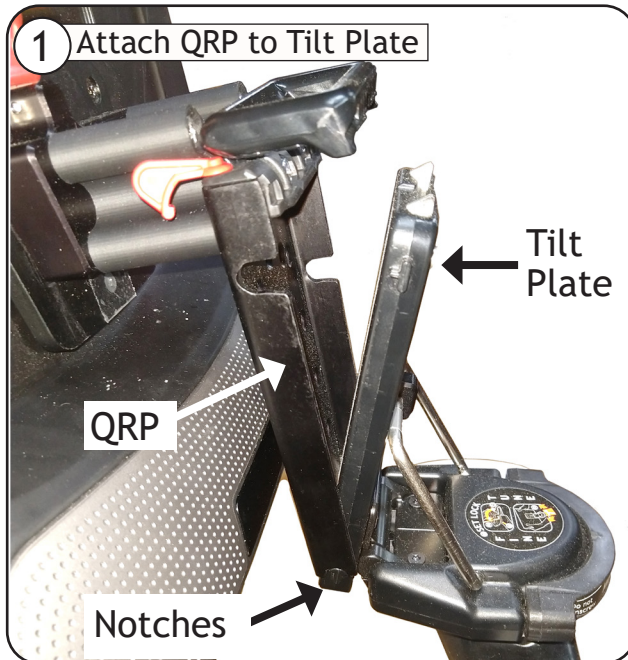

First connect the notches on bottom of the QRP to the protruding pins at the bottom of the Tilt Plate.

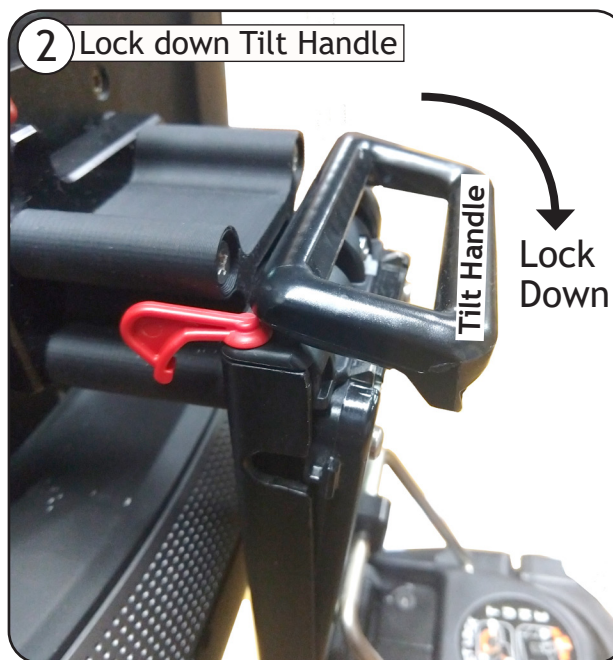

Lock down the black Tilt Handle.

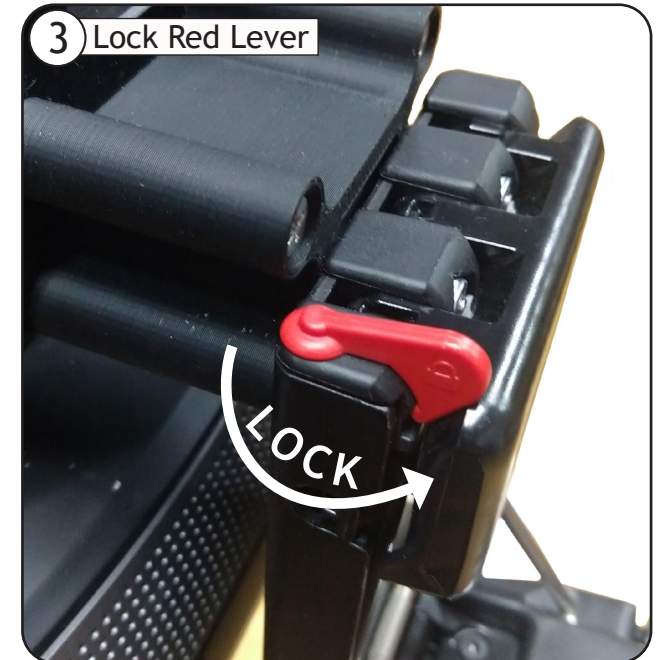

Swing RED LOCK LEVER into lock position. This locks down the Tilt Handle.



28 Tobii I-13 fully attached and locked in place

Remove Tobii I-13 or I-16 from Mount'n Mover



Push RED TAB and lift device up



Tobii I-13 detached from Mount'n Mover

Set up for IR Remote Control Access for the I-13 and I-16 (DP-T5 + DP-EXT)

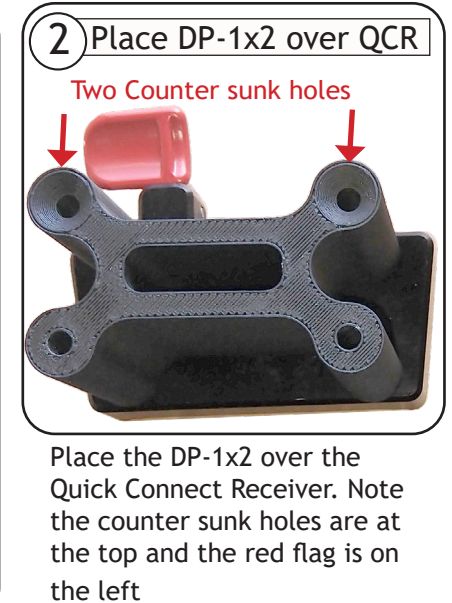
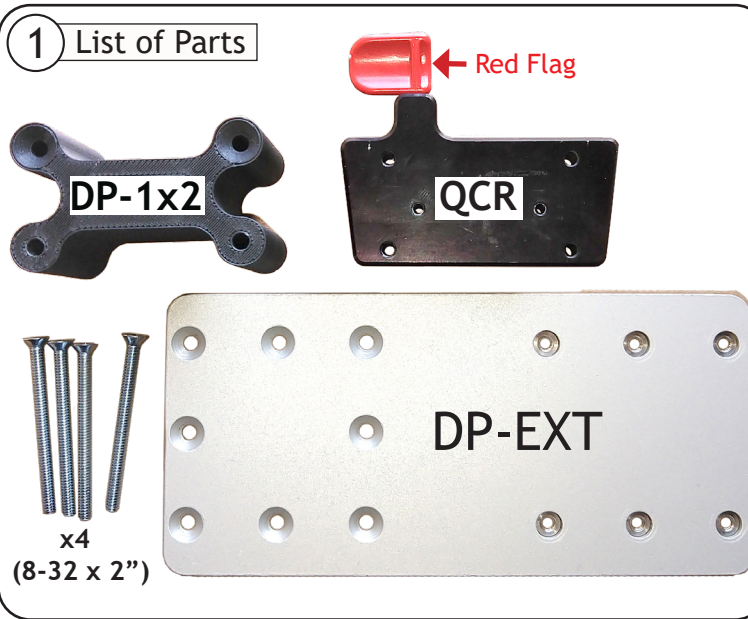
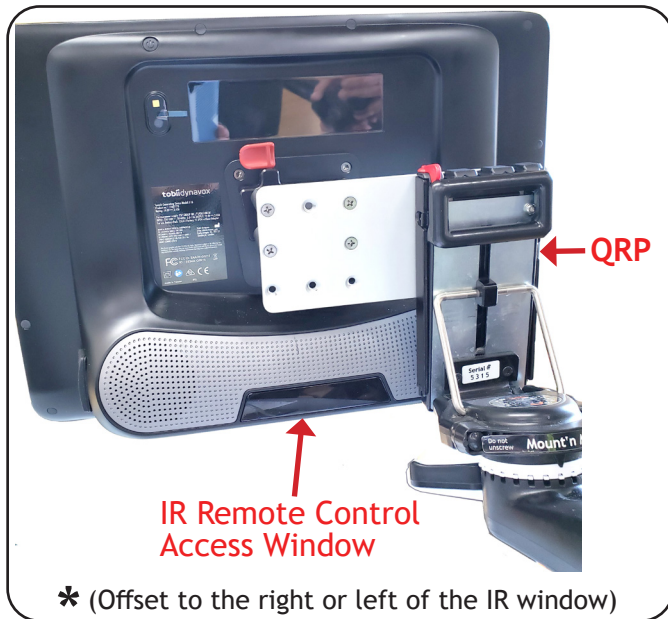

Parts needed are the DP-T5, the DP-EXT (Extension Plate), and the Quick Release Plate QRP (included with the Mount'n Mover)

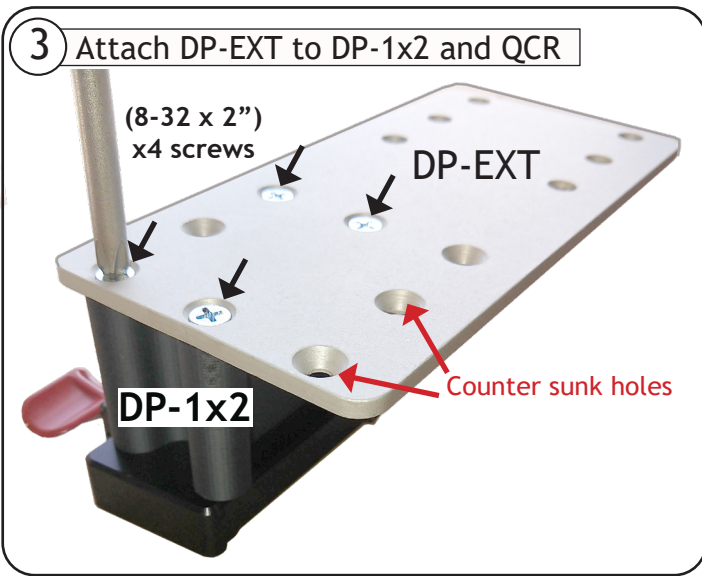

Place DP-EXT over the DP-1x2 and use the four screws to attach all three parts together. Note the countersunk holes on the DP-EXT are facing up.

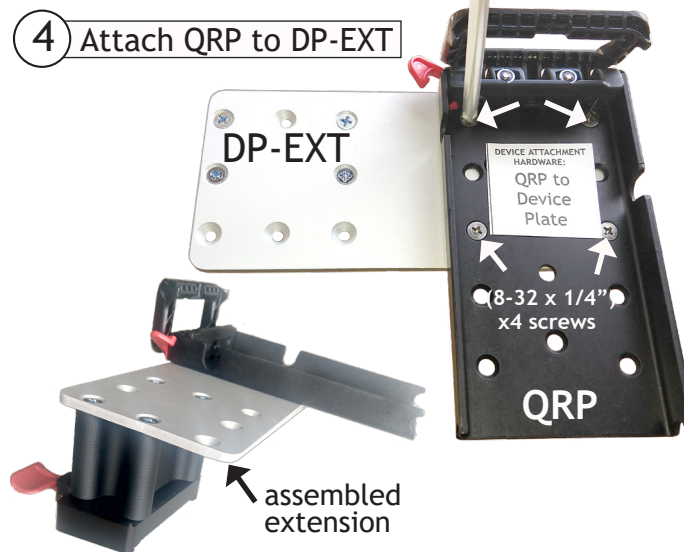

Place the Quick Release Plate (QRP) over the DP-EXT and attach to the threaded inserts in the EXT with four (8-32 x 1/4") screws (labeled QRP to Device Plate)

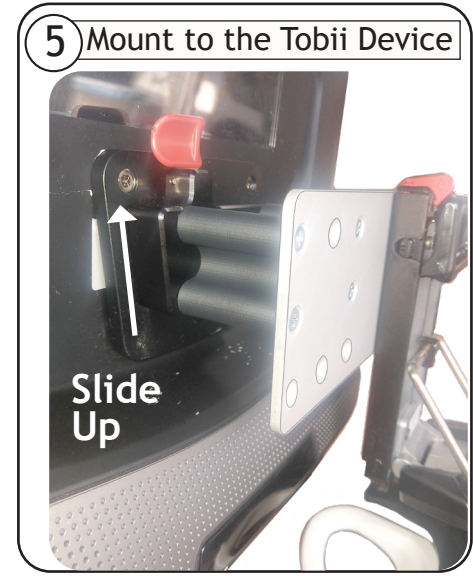

Slide the Extension up onto the connecting grooves on the Tobii plate until it "clicks" in place

DP-EXT (Extension Plate)

(x4) 8-32 x 1/2"
Screw X



(x4) 8-32 x 1/4"
Screw T



Use to lower the device
for easier access.

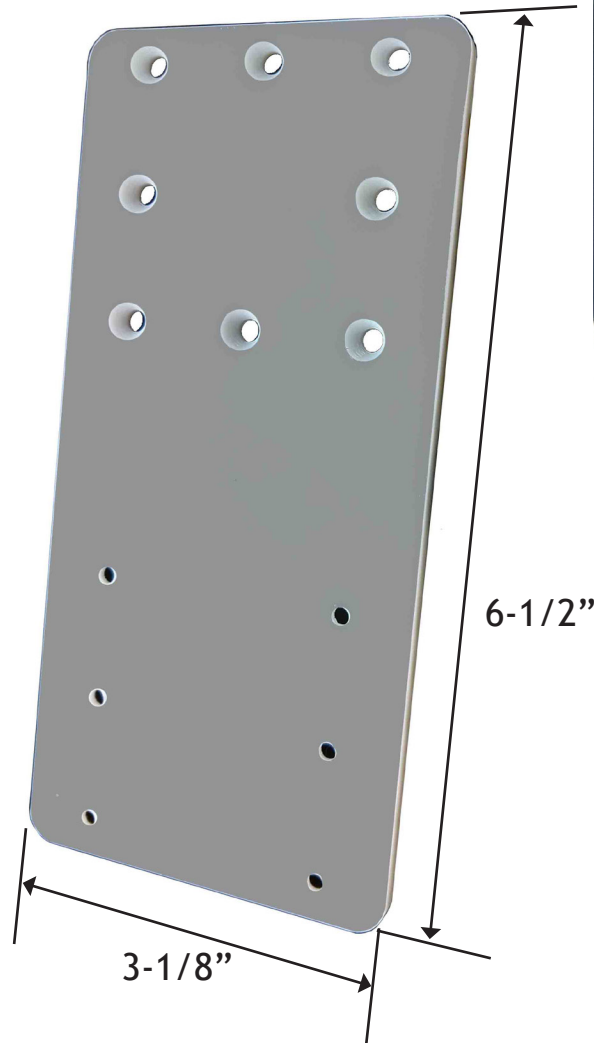

Offset to access the infrared
window on Tobii i13 and i16



Use on larger devices to attach the
Quick Release Plate lower to clear
the white hoop and paddle



Mount'n Mover™
by BlueSky Designs

mountnmover.com

Product: DP-EXT (Extension Plate)



DP-UR Universal Rotator

Attaches to: All Mount'n Mover device plates and trays

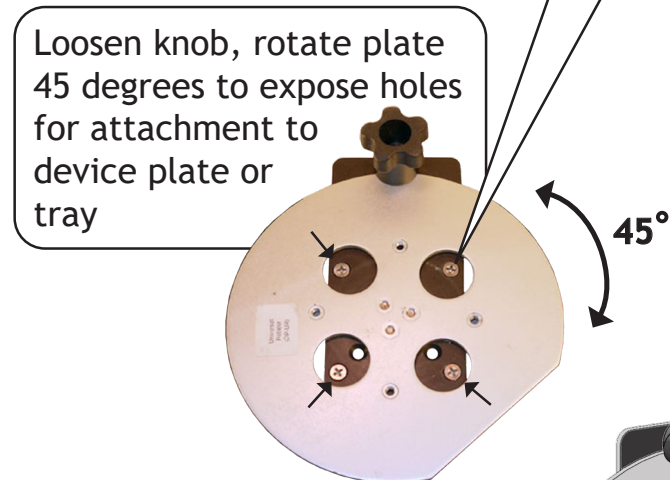
Universal rotator to device plate or tray
(These screws are not provided with Universal Rotator; Provided with device plate)
8-32 x 1/4" Flathead Screws (x4)

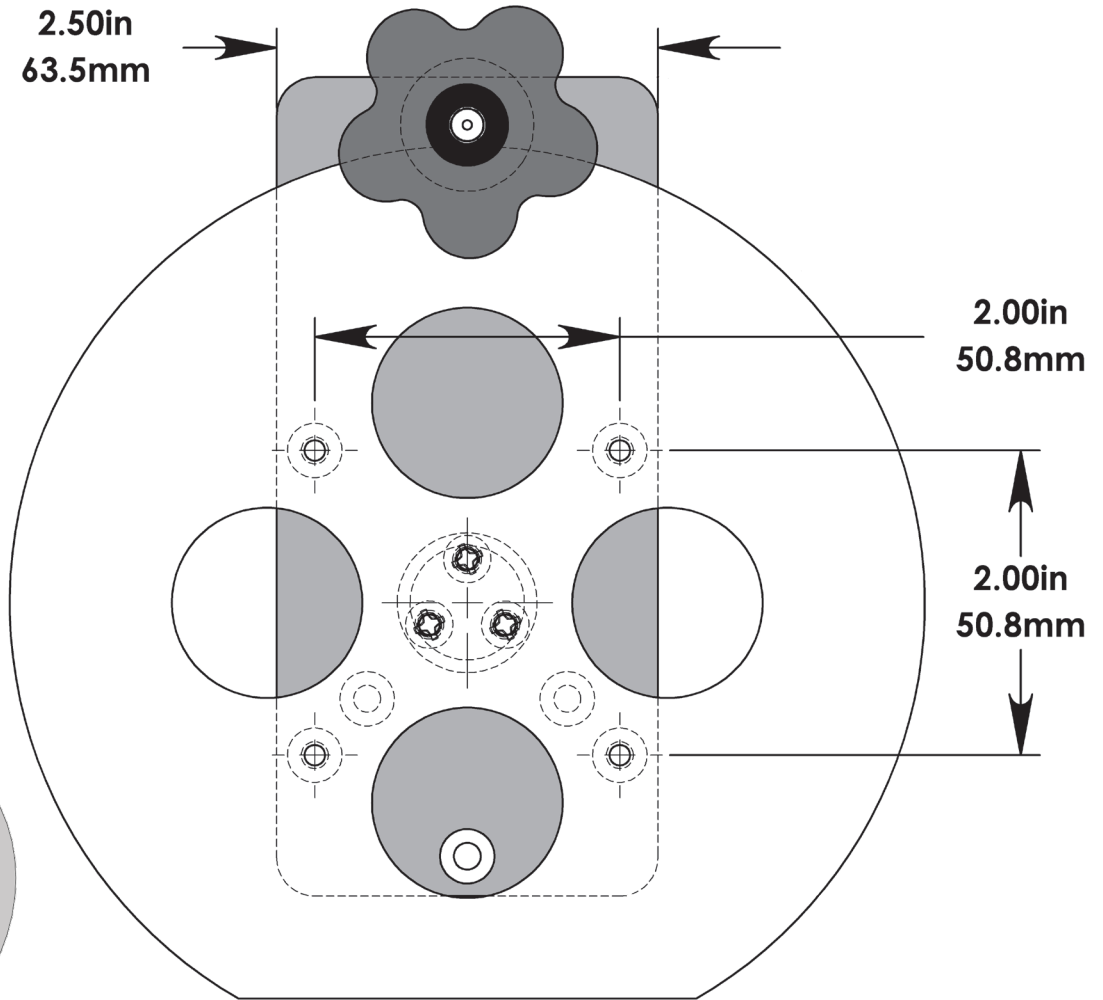

Align with holes to attach Quick Release Plate (QRP) (supplied)
8-32 x 3/16" (x4)



Universal Rotator (UR) *

If you use too long of screws the rotator will not turn! Must use 8-32 x 1/16 inch long screws included with rotator

Attach device plate DP-QCR to device
(shown with Accent 1400)



To adjust rotation:

1. Loosen knob
2. Rotate device
3. Tighten knob

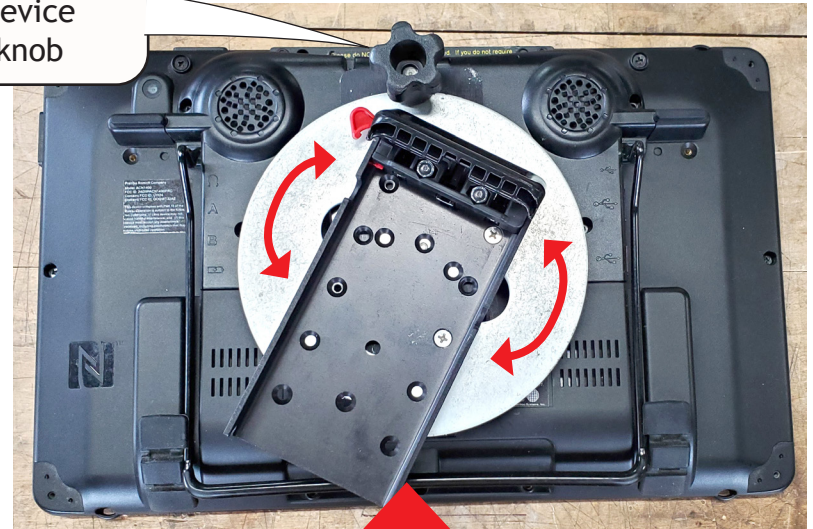

1. Loosen knob
2. Rotate plate to expose device attachment holes

ATTACH UR

3. Screw UR to device plate (DP-QCR)

8-32 x 1/2 (x2)

ATTACH QRP

Screw QRP to UR.
Four screws included with QRP (8-32x3/16)

* If you use too long of screws the rotator will not turn!

Orient rotator flat to bottom of QRP

DP-QCP Quick Connect Plate



DP-QCR Quick Connect Receiver

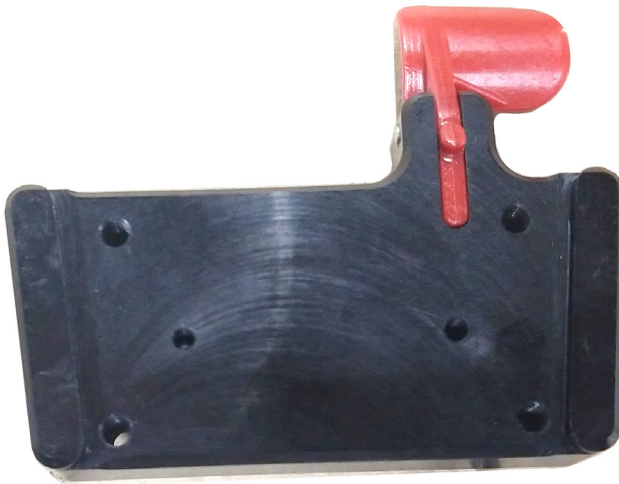

Angled slots in the DP-QCR line up with angles on the edges of the DP-QCP. The DP-QCR slides onto the DP-QCP starting from the bottom. Slide the DP-QCR up until it “clicks” into the lock position.

Attach the Quick Release Plate (QRP) to the Quick Connect Receiver (QCR)
See page 34.

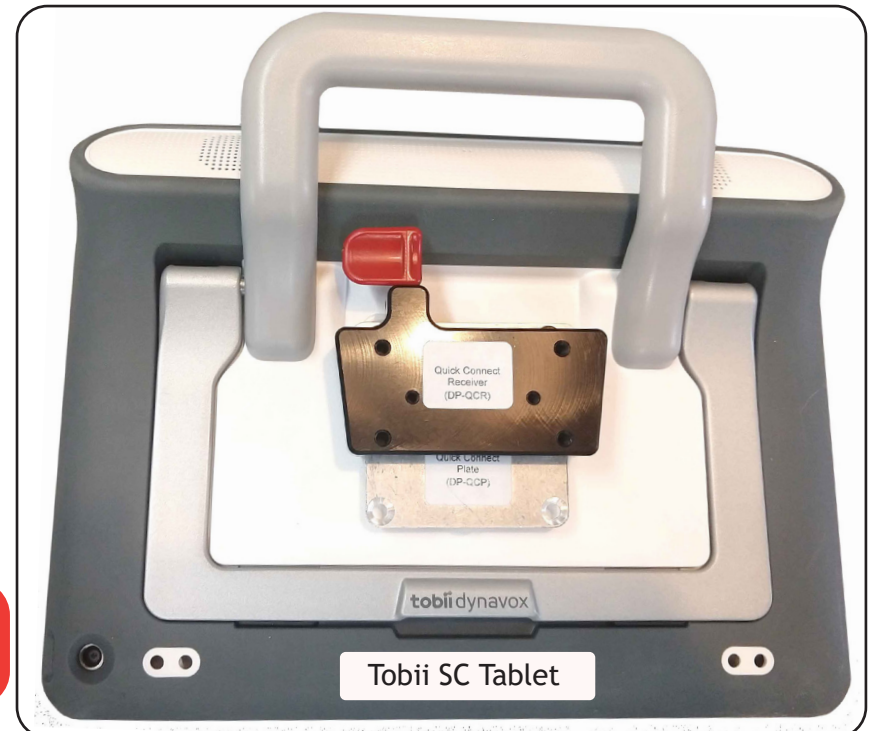
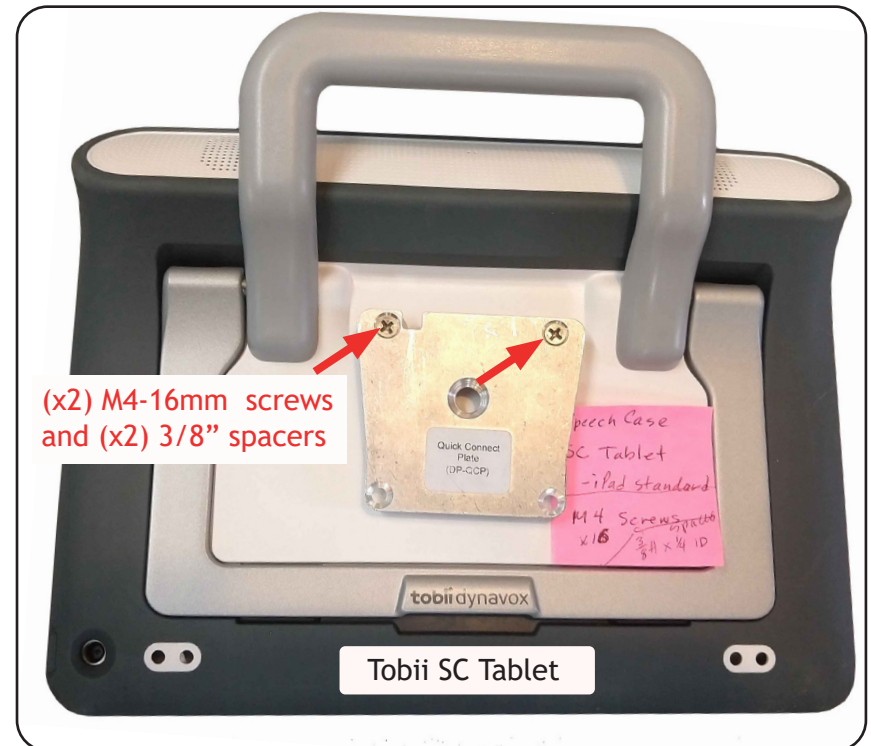

Mounts and Accessories

Easy Mover Instructions

To Tighten or Loosen Joints



Attach the Quick Connect Receiver (QCR) to the Quick Connect Plate (QRP)



Quick Connect Receiver (QCR) and the Quick Release Plate (QRP). Attach the QCR to the QRP with four screws (8-32 x 1/2 inch) included with the Quick Connect Receiver. *Note the grooves on the QCR

EASY MOVERS



Dual Arm Easy Mover with locking tilt plate. The angle of the device can be locked in.

Easy Movers do not have the preset locking positions but each joint can be adjusted to your preferred tightness / looseness.



Dual Arm Easy Mover with non-locking tilt plate and Single Arm Easy Mover with Quick Connect Receiver.

Easy Movers DO NOT come with a QRP

Dual Arm Mount'n Mover overview

Paddle releases the tilt plate



Hoop releases the elbow and shoulder joints

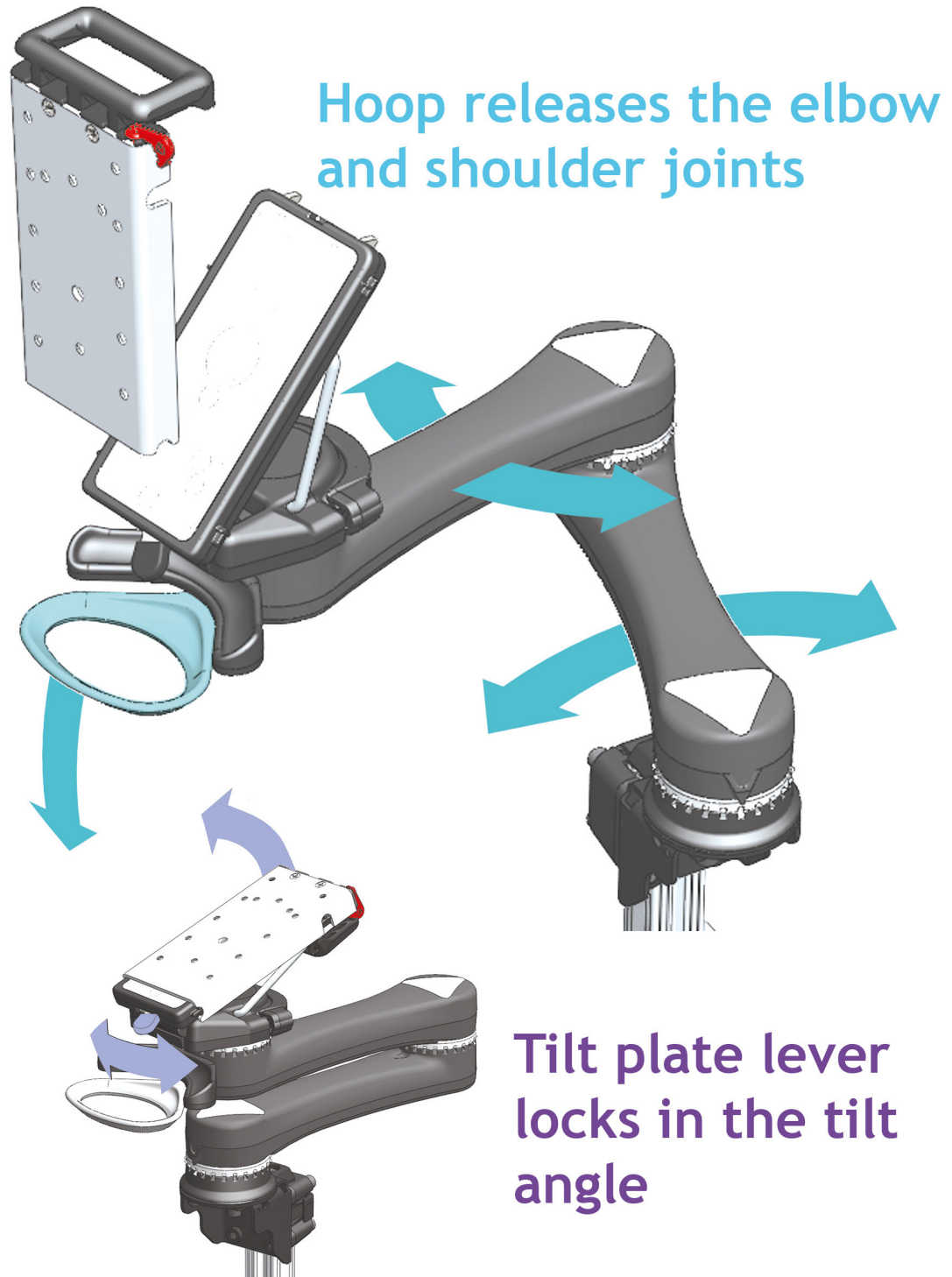

Tilt plate lever locks in the tilt angle

How to set a “lock” position

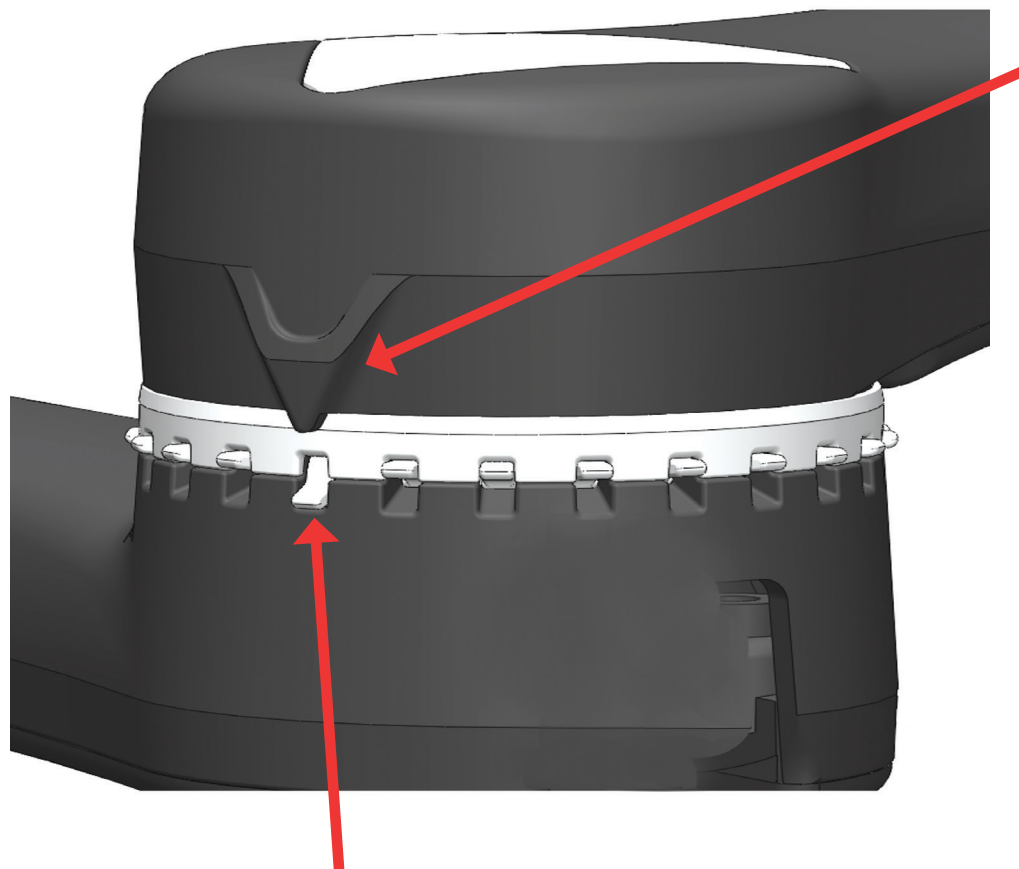

Lock Tab in the “down” position.

At each joint there is a black “arrow”. Whenever this arrow moves across a down lock tab...it locks in that position. To release shoulder and elbow, push on white hoop. To release wrist, push on black paddle.

*** NOTE ***

Do not try to lift up (unlock) the lock tab when the black arrow is over it.

This will cause the lock tab to break or bend.

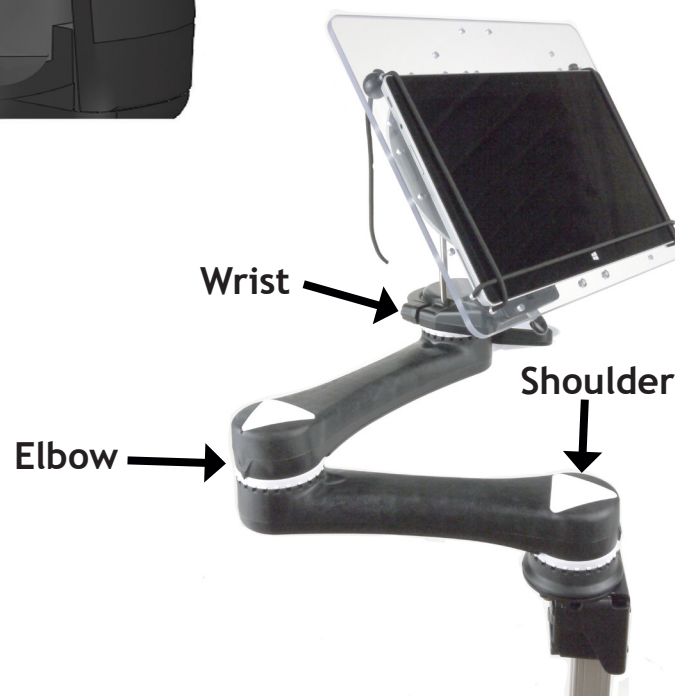

A Suggestion for Positioning:

With all lock tabs “UP” at each joint, move device into desired position.

Once in position for use, look at the black arrow at each joint (shoulder, elbow, wrist).

Put down a lock tab closest to the black arrow at each joint.

**Posts come in lengths 8, 12, 18, 24, and 36 inches
Custom lengths also available!**



Table Clamp (TC)



Avoid clamping to surfaces less than 0.25 (0.635 cm) thick

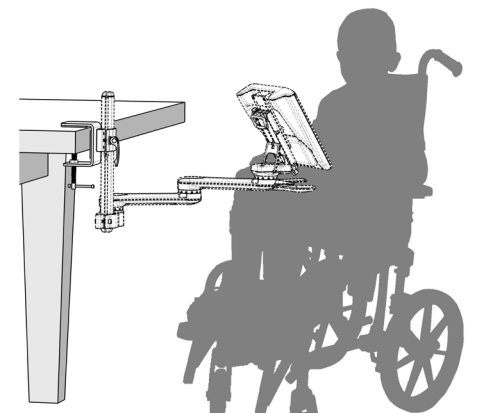
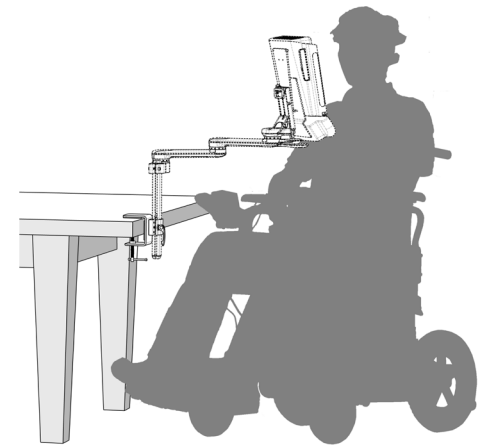
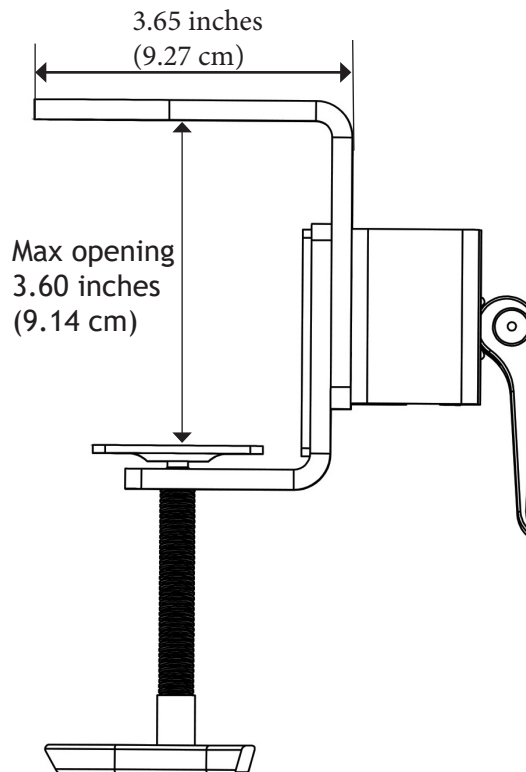
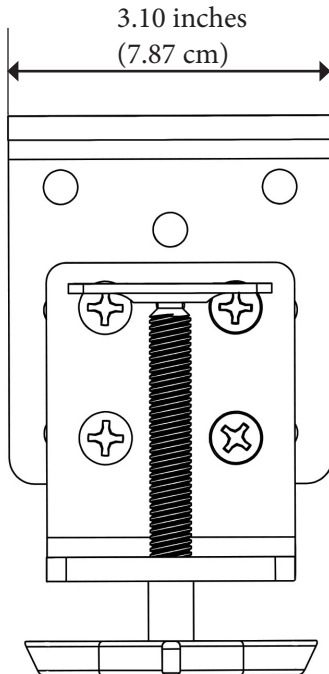

Post Clamp Extension (WB2-EXT)

Not usually included in Eval kit unless requested

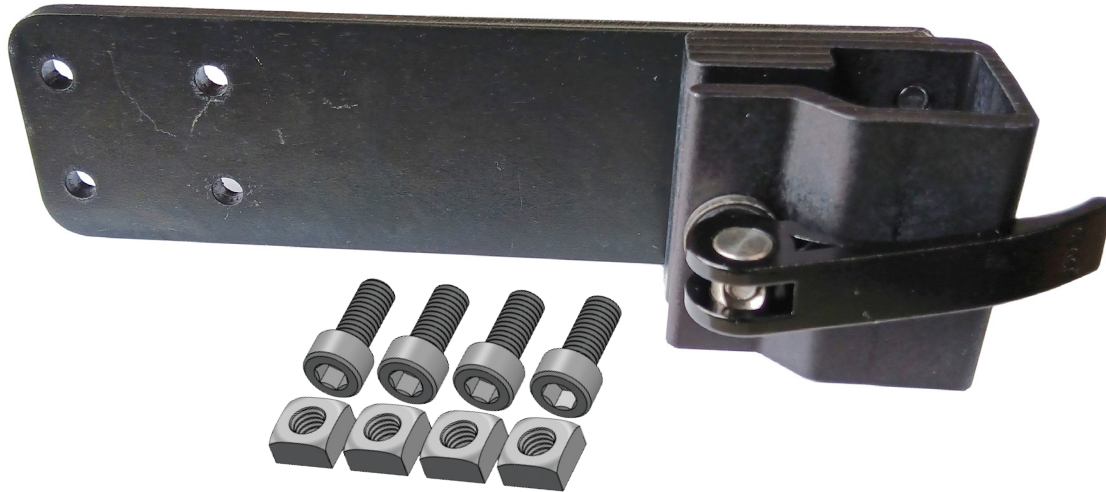

The WB2-EXT comes with hardware to attach to the Permobil seat rail. Attaching to the Quantum track would require a T-Nut



WB2-EXT attached to the Permobil seat rail track

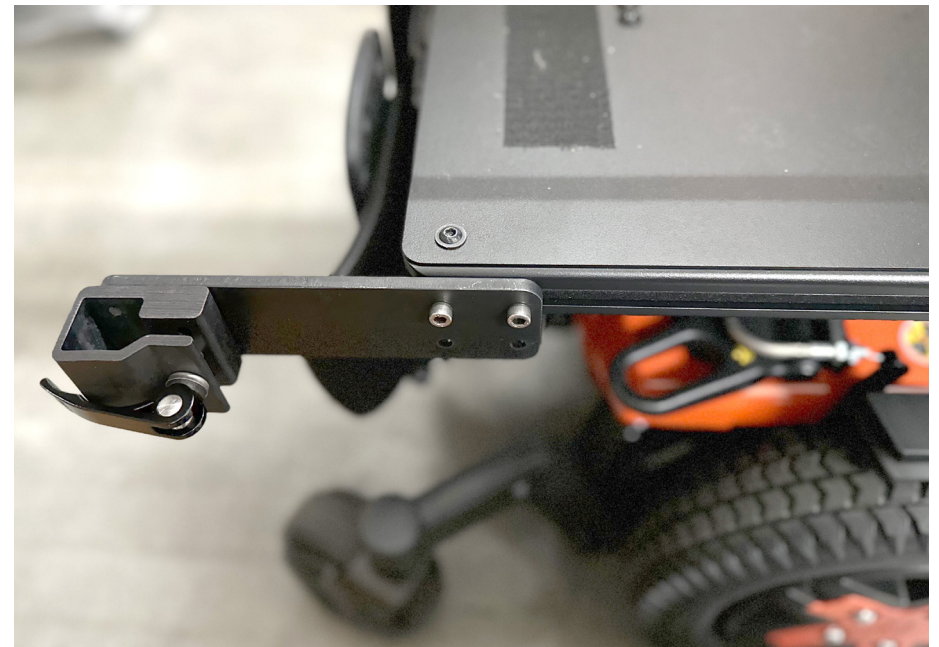

WB2-EXT attached to the Quantum Edge 3 seat rail track (T-Nut would be needed)

Choose a mount that best fits your needs and abilities!

Manual

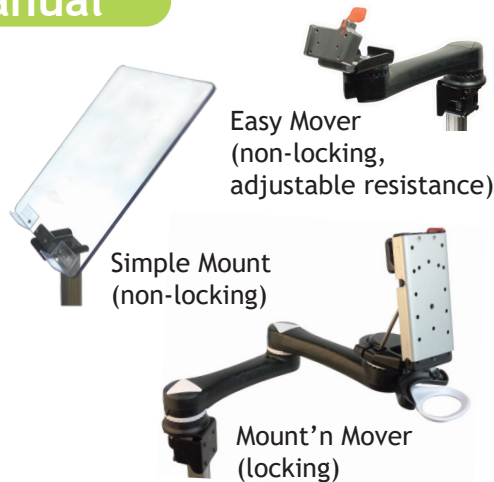

Manual models are easily operated one-handed

Our movable mount comes in dual-arm, single-arm and simple models, offering a wide range of choices based on your needs.

Motorized Pow!r

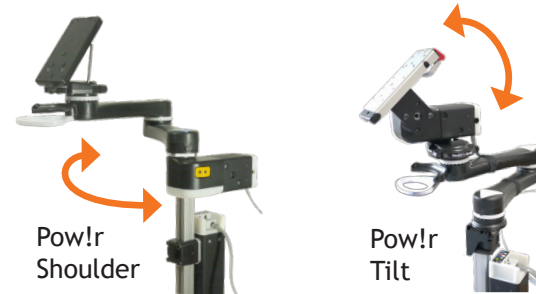

The Pow!r models' rotary joints move with the touch of a switch

Use it to:

- Bring a backpack within reach
- Independently bring a suction or hydration tube to your mouth
- Adjust the tilt angle of an eyegaze system to see for driving



Shane rotates joystick out of the way with the Pow!r Mount

Accessorize to fit your life!

Our attachment release design makes swapping out a device or tray a snap!

Attachment plates for speech generating devices



Multitask!

Combine mounts to secure and position multiple devices at the same time.



Double-decker system!

Trays for every use!



Mount laptops, iPads, tablets, phones, cameras, eating and reading trays or custom.

The Eval Kit includes: 1. A Large Laptop Tray.
2. A Large Tablet Tray or an iPad Tray (your choice).



Laptop Tray
(TR-LT)



Large Tablet Tray
(TR-LG)

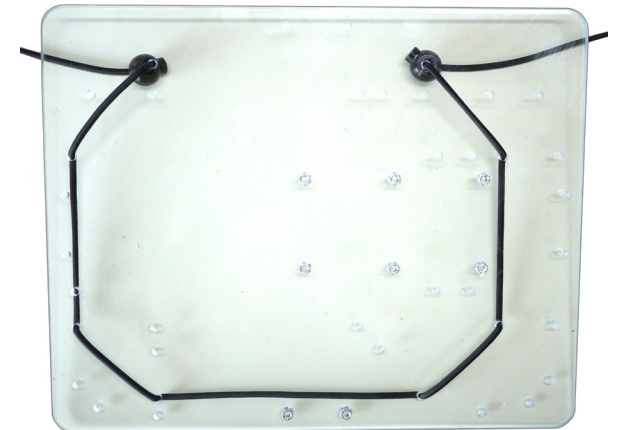

iPad Tray
(TR-iTab)

Link Cube Configurations

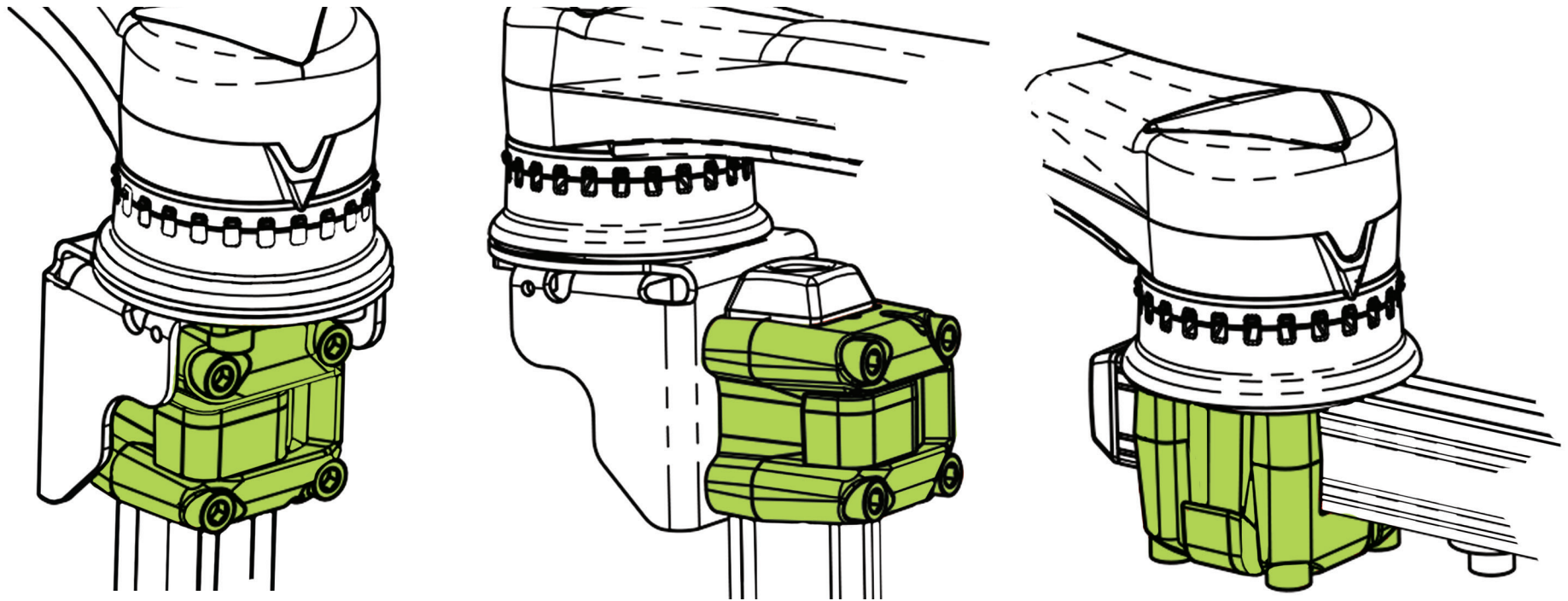

The Link Cube (in green), can be removed by taking out the four bolts and reattaching it in the configuration of your choice.

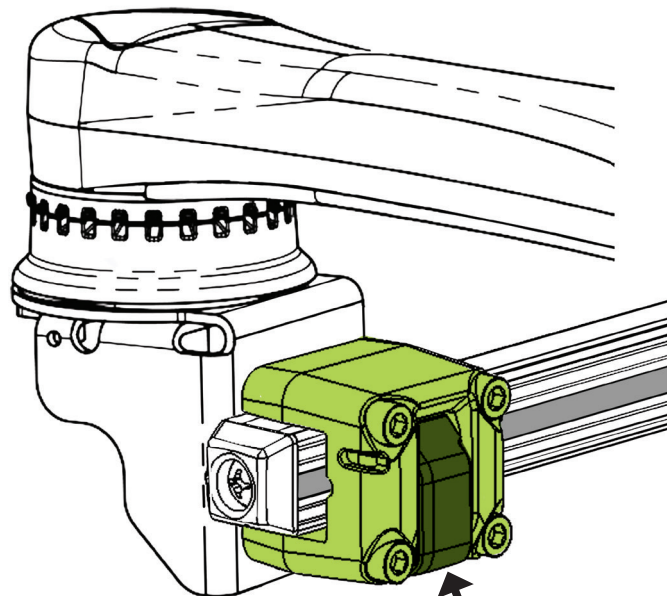

* Link Cube Lever

*** NOTE:**

If the four bolts are too tight the Link Cube Lever will not work as designed. You should be able to close the Link Cube Lever to lock the mount on the post. If you cannot close/open the lever, the four bolts are too tight.

This configuration gives more forward reach of the mount.

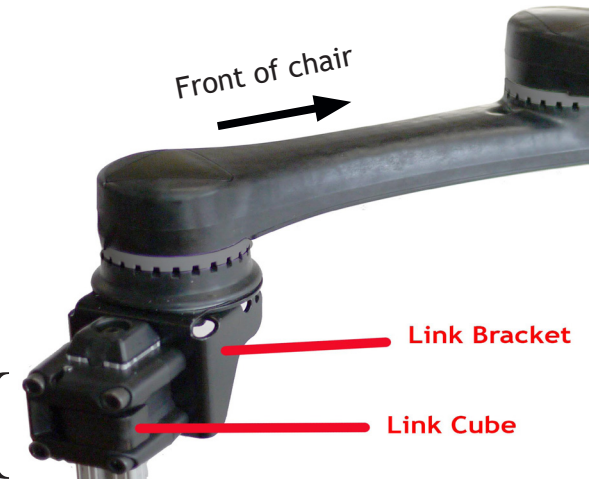

Multi Mounting Systems

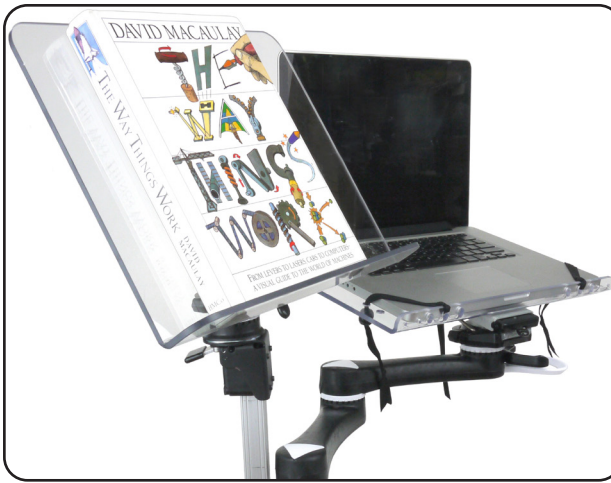

See our website (or call us!) for many more examples

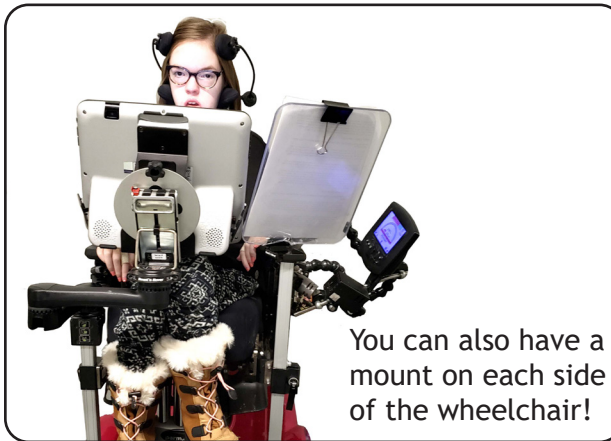

You can also have a mount on each side of the wheelchair!



Two dual arm mounts on one post

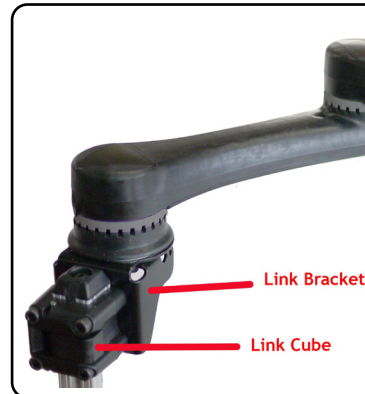

For two mounts on one post, move the link cube to the outside of the link bracket. This allows you to slide the mount lower down on the post.

Mount'n Mover™

by BlueSky Designs

THE MOUNT MENTOR EVAL SHEET

Need help building a mounting system? Please complete the following steps and return to: info@blueskydesigns.us

Step 1. Complete section A

Step 2. Take photos as described in section B

Step 3. Provide post length determined in section C

Step 4. Complete wheelchair frame information in section D

* We will contact you with a quote. Additional support for installation and use is available via phone, Skype, or email.

A Lets get started....first we need some information:

Contact Person

Organization _____

Name _____

Title _____ Phone # _____

Email _____

Attach to: (Check all that apply)

☐ Wheelchair (Make/Model) _____ *

☐ Power _____

☐ Power Standing

☐ Manual _____

With manual w/c does client apply brakes? Y ☐ N ☐

☐ Tilt/Adjustable _____

Do you need to remove both foot rests? Y ☐ N ☐

☐ Stroller _____

☐ Walker/Gait Trainer _____

☐ Bed _____ * Include photos

☐ Floor Stand ☐ Table

Device / Tray [See website for Device Plate Graph](#)

☐ SGD or AAC make/model _____ *

☐ If Tobii I-13 or I-16 will the client use IR feature? _____

☐ Does Device have QRM/UDS bracket? _____

☐ Phone make/model/dimensions _____

☐ Tablet-iPad Make: _____ Model: _____

Dimensions: _____

☐ Rotate portrait to landscape required?

☐ Laptop Tray ☐ 12 x 16 Tray

Require access to more than one device? Y ☐ N ☐

If yes: ☐ At the same time

☐ Change as needed

☐ Two Mounts: ☐ one post - (double decker)

☐ two posts

BlueSky Designs
2637 27th Ave South
Suite 209
Minneapolis, MN 55406
612-724-7002
www.mountnmover.com
info@blueskydesigns.us

* required info

Client (Optional)

Name/initials _____

Age _____ Diagnosis _____

Client Characteristics

How does client access their device?

Direct Select ☐ Switch ☐ Eyegaze/Head Tracker ☐

If direct select:

Light touch ☐ Medium touch ☐ Strong touch ☐

Will the client move it? Y ☐ N ☐

If yes, what arm preference? Left ☐ Right ☐ Both ☐

Can they cross midline? Y ☐ N ☐

How does client drive Power Wheelchair?
(if applicable)

Hand joystick on: Left ☐ Right ☐

Chin joystick ☐ Head array ☐

Prefer to mount on: Right side ☐ Left side ☐

Is there an existing tray on w/c? Y ☐ N ☐

If yes, will it need to be used at
the same time as the mount? Y ☐ N ☐

Will footrests need to be
rotated or removed? Y ☐ N ☐

Preferred Mount(s) www.mountnmover.com

☐ Locking

Dual ☐ Single ☐ Tilt'n Turner ☐

☐ Non-Locking (adjustable resistance)

Dual ☐ Single ☐ Tilt'n Turner ☐

☐ Pow!r Mount

Pow!r Shoulder ☐ Pow!r Tilt ☐

☐ Simple (tray on post)

Large ☐ Small ☐

☐ Not sure

B Attaching the Mount'n Mover pictures are very useful!

Please send JPEGs of each of these views to info@blueskydesigns.us



Angled view



Side view



Front view



close-up view

Pointers:

- Hold the device where you want it in relation to the client
- Move lap belts, blankets etc so the frame is visible
- Please include client in wheelchair.

✳ See website for wheelchair examples and more specific information

C Determining Post Length - A

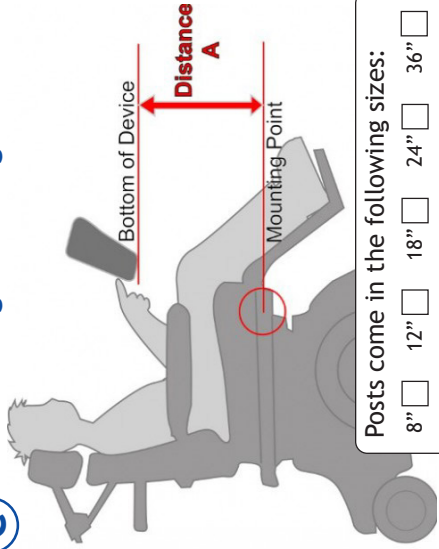

Posts come in the following sizes:

8" ☐ 12" ☐ 18" ☐ 24" ☐ 36" ☐

Need a custom size? _____"

Components Overview

1. Wheelchair hardware

2. WB2 (wheelchair bracket)

3. Post

4. Arm (single or dual)

5. Device plate or tray

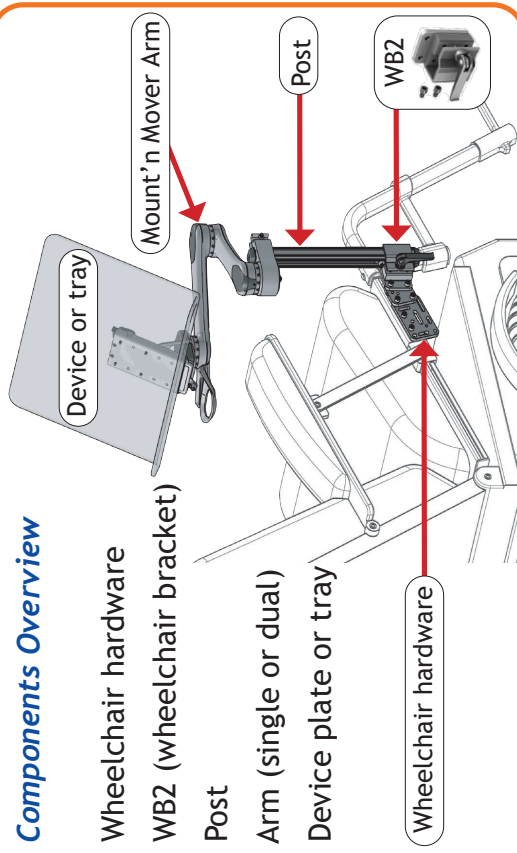

D What type of frame do you have?

☐ Permobil Unitrack Frame

☐ Single slide track
(Invacare, Quantum, Amy)

☐ Round tubing
Please measure circumference

☐ Round tubing with holes

Circumference measurements:

Horizontal tube _____

Vertical tube _____

NOTES: _____

Measuring your round tubing for correct clamp size

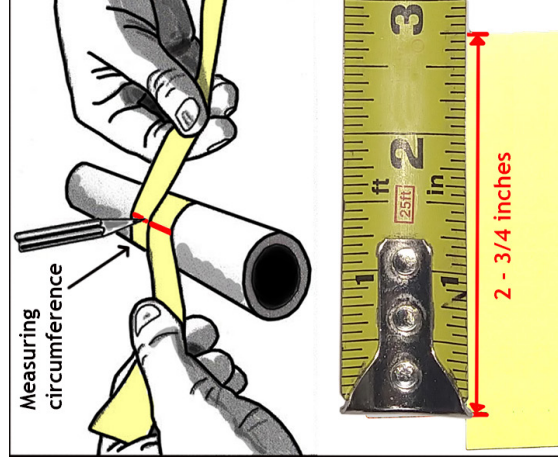

Common Clamp Sizes

Circumference	Diameter
2 3/4"	7/8"
2 3/8"	3/4"
3 3/16"	1"
3 17/32"	1 1/8"
3 29/32"	1 1/4"
4 5/16"	1 3/8"

*We can fit many more sizes than shown above. Just tell us your circumference!

See wheelchair mounting guides on our website (www.mountainmover.com)
If you don't see your chair...call us!

