

# DP-T5 Attaching the Tobii I-13 or I-16 to a Mount'n Mover with a Tilt Plate

## Tobii I-13

### 1 DP-T5

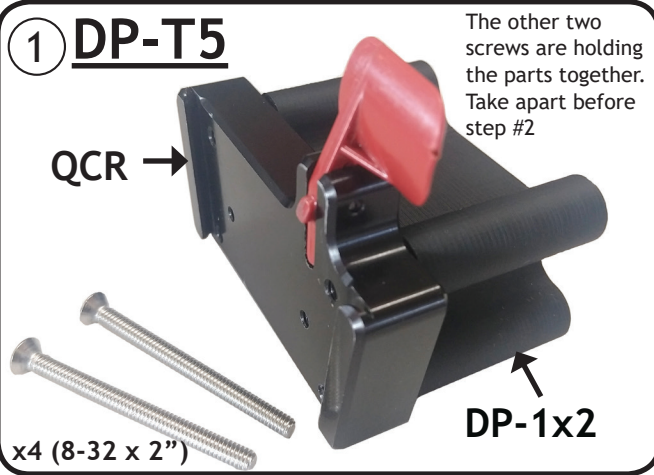

The DP-T5 consists of the Quick Connect Receiver (QCR), the DP-1x2, and four 8-32 x 2" screws.

### 2 Assemble QRP to DP-T5

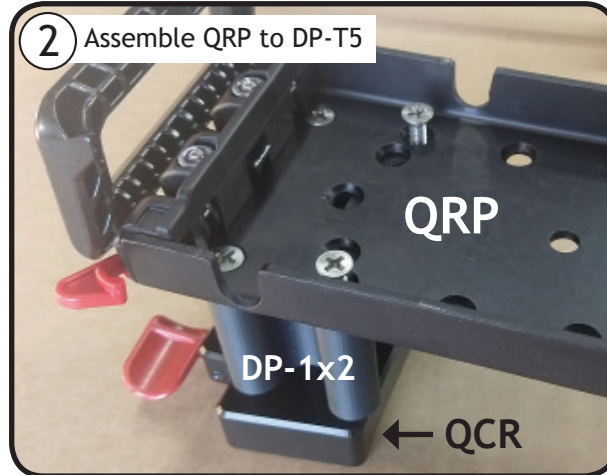

Use the four screws that come with the DP-T5 to go through the Quick Release Plate (QRP), through the DP-1x2 and into the Quick Connect Receiver (QCR)

### 3 Attach QCR to Tobii Device

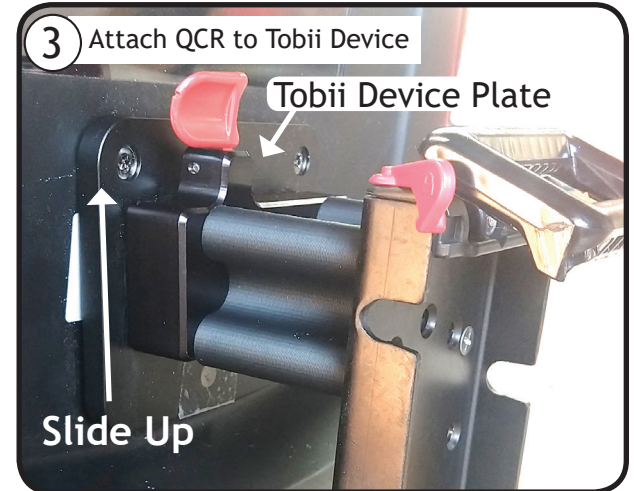

Slide the DP-T5 onto the connecting grooves on the Tobii device plate until it "clicks" in place.

## Tobii I-16 \* Reconfigure screws for an I-16

### 1 Attach the DP-1x2 to the QCR

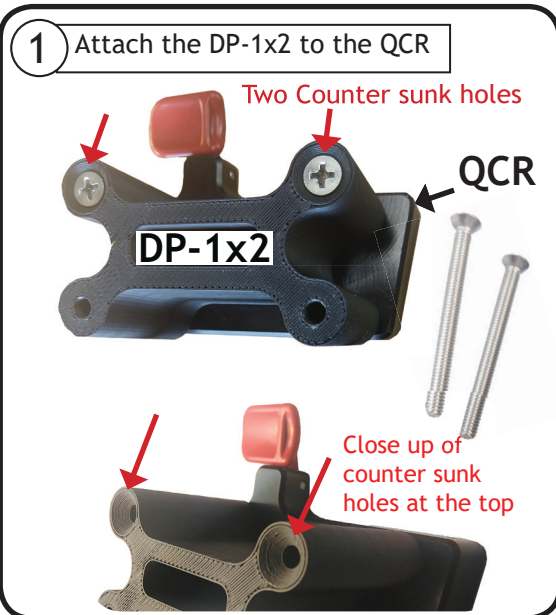

Attach the DP-1x2 to the QCR with TWO of the 2" screws (use the two counter sunk holes)

### 2 Attach QRP to DP-T5

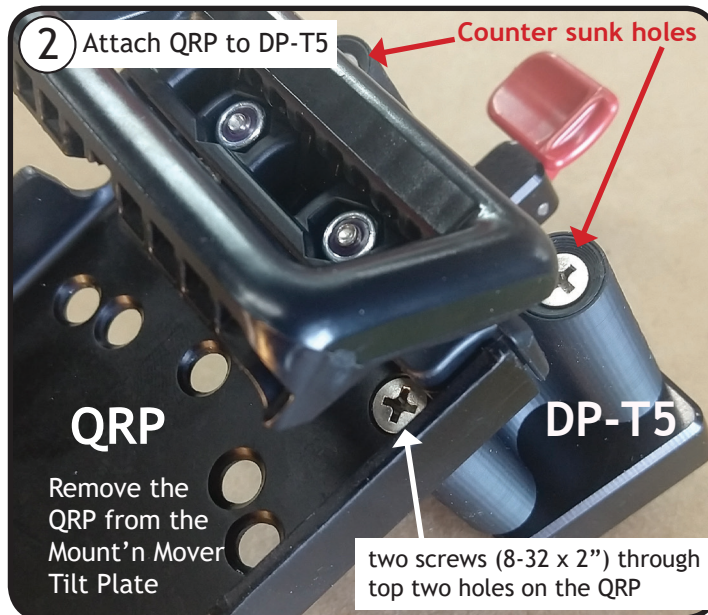

Quick Release Plate is attached using the other TWO 2" screws. Go through the QRP, the DP-1x2, and into the lower two holes on the QCR.

### 3 Attach QCR to Tobii Device

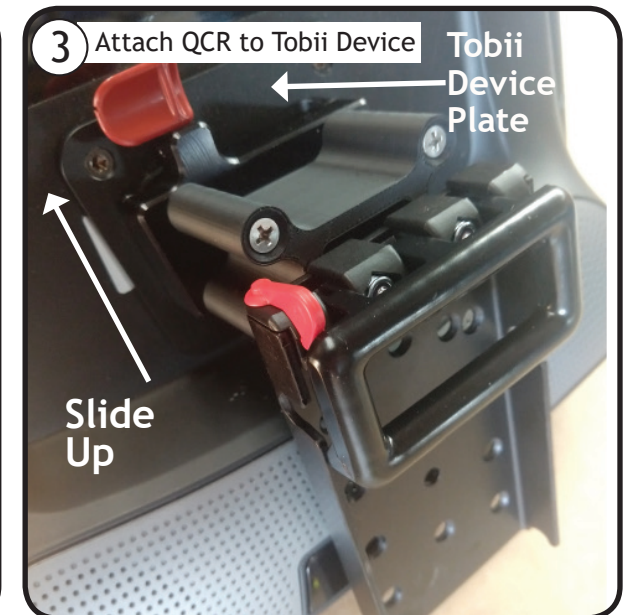

Slide the DP-T5 onto the connecting grooves on the Tobii device plate until it "clicks" in place.

# DP-T5 Attaching the Quick Release Plate (QRP) to the Tilt Plate

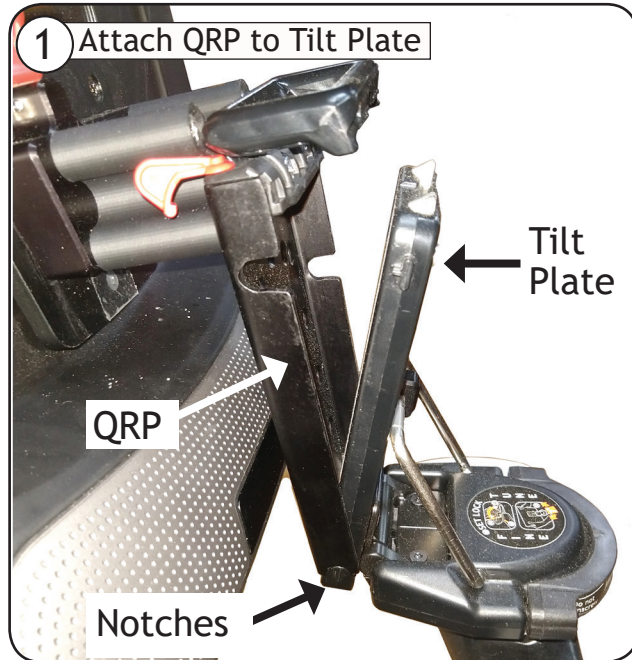

First connect the notches on bottom of the QRP to the protruding pins at the bottom of the Tilt Plate.

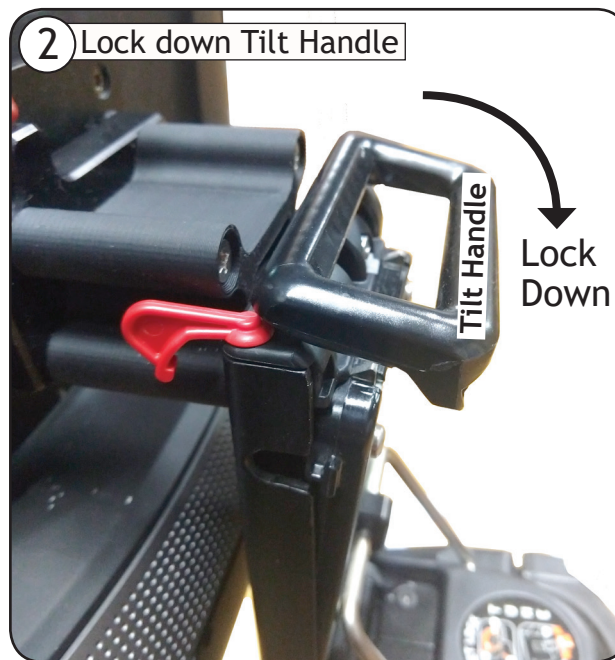

Lock down the black Tilt Handle.

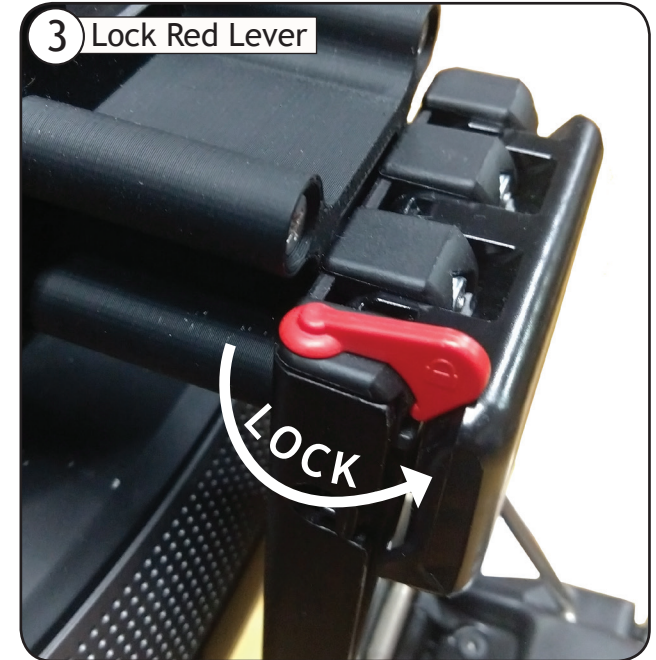

Swing RED LOCK LEVER into lock position. This locks down the Tilt Handle.



Tobii I-13 fully attached and locked in place

## Remove Tobii I-13 or I-16 from Mount'n Mover



# Set up for IR Remote Control Access for the I-13 and I-16 (DP-T5 + DP-EXT)

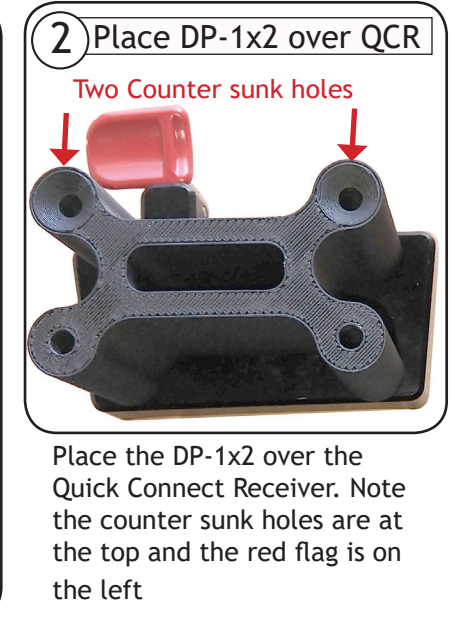
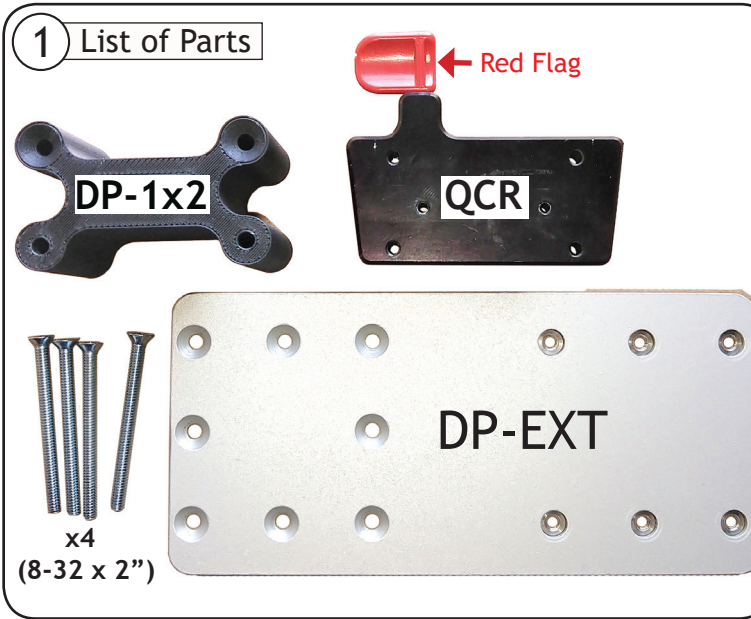

Parts needed are the DP-T5, the DP-EXT (Extension Plate), and the Quick Release Plate QRP (included with the Mount'n Mover)

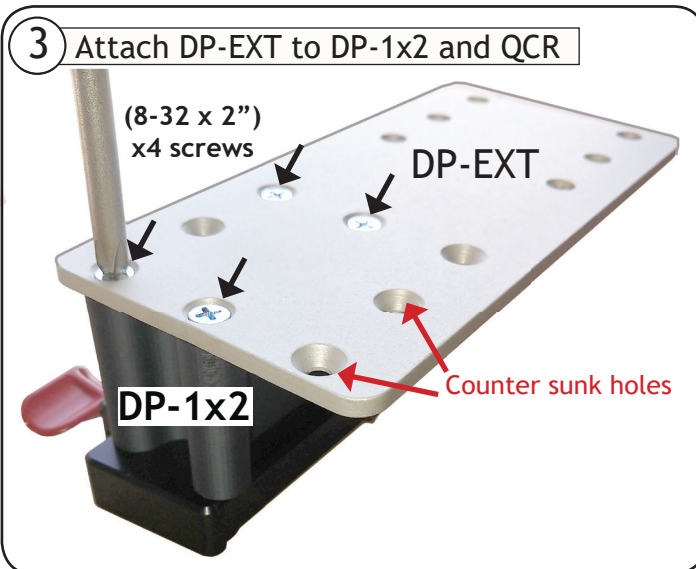

Place DP-EXT over the DP-1x2 and use the four screws to attach all three parts together. Note the countersunk holes on the DP-EXT are facing up.

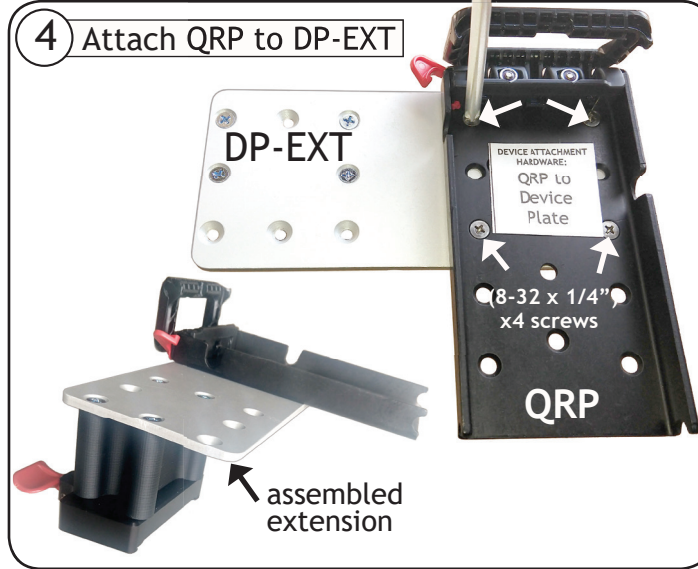

Place the Quick Release Plate (QRP) over the DP-EXT and attach to the threaded inserts in the EXT with four (8-32 x 1/4") screws (labeled QRP to Device Plate)

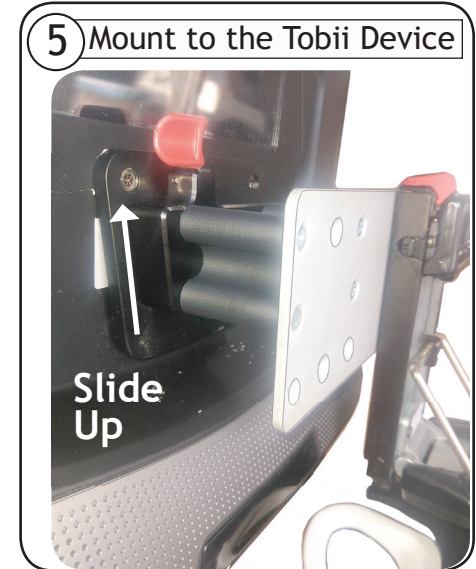

Slide the Extension up onto the connecting grooves on the Tobii plate until it "clicks" in place

# Set up for I-13 and I-16 with a Universal Rotator (DP-UR)

## A Set up for IR access



Rotator used with Extension plate for access to Infrared window.

### 1 Parts needed

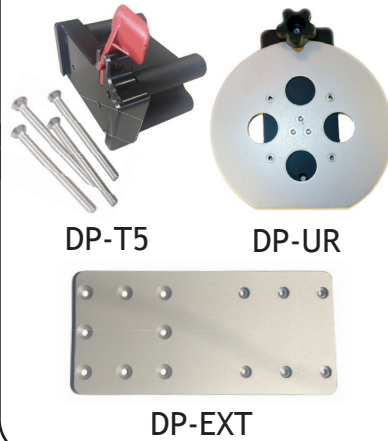

The DP-T5 includes:  
1. Spacer  
2. QCR  
and four 8-32 x 2" screws

### 2 Turn Rotator

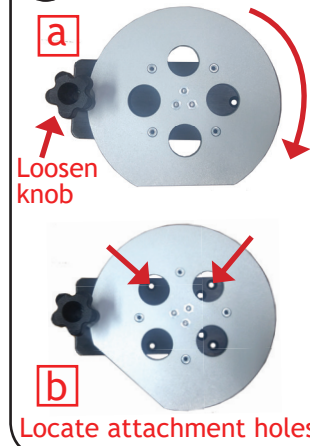

Loosen the knob and spin the Rotator to reveal the attachment holes.

### 3 Attach DP-UR to DP-T5

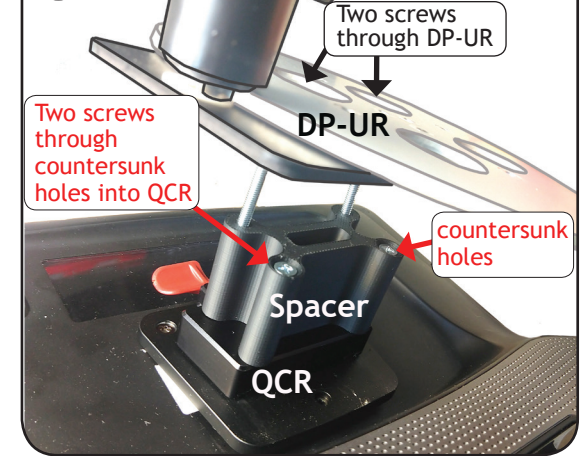

Use two of the 8-32 x 2" screws through two of the holes in the DP-UR, through the DP-T5 spacer, and into the threaded holes in the QCR. The other 2" screws attach the spacer to the QCR.

### 4 Attach DP-EXT to DP-UR

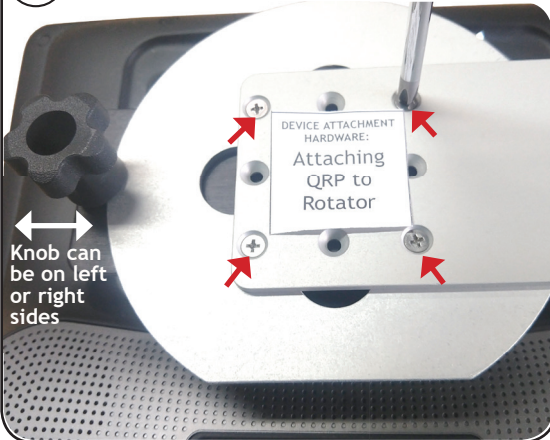

Attach the Extension Plate (DP-EXT) to the Rotator (DP-UR) with four screws labeled "Attaching QRP to Rotator" (8-32 x 3/16"). Note the Rotator knob can be on left or right side.

### 5 Attach QRP to DP-EXT

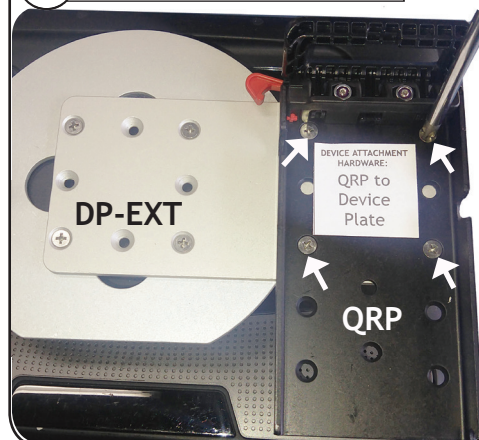

Attach the QRP to the threaded inserts on the DP-EXT with four screws (8-32 x 1/4") labeled "QRP to Device Plate".

## B No IR access



Attach the QRP to the threaded inserts on the DP-UR with four screws (8-32 x 3/16") labeled "QRP to Rotator".

### 1 Parts needed

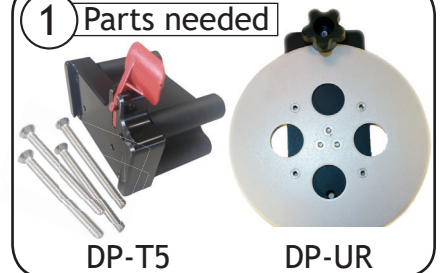

(See above steps #2 + #3)

### 2 Turn Rotator

### 3 Attach DP-UR to DP-T5

### 4 Attach DP-UR to QRP

