

Mounting Instructions for Tobii Dynavox EM-12 with EyeMobile Plus and Tobii Dynavox Indi

Tobii Dynavox EM-12 with EyeMobile Plus

Mounting Instructions



Tobii Dynavox's Quick Release Adapter Plate for I-110 and EyeMobile Plus. Comes in the box but is not attached



Attach Tobii's Quick Release Adapter Plate to the back of the case with the provided screws.



Slide the DP-QCR onto the Quick Release Adapter Plate until it "clicks" and locks in place.

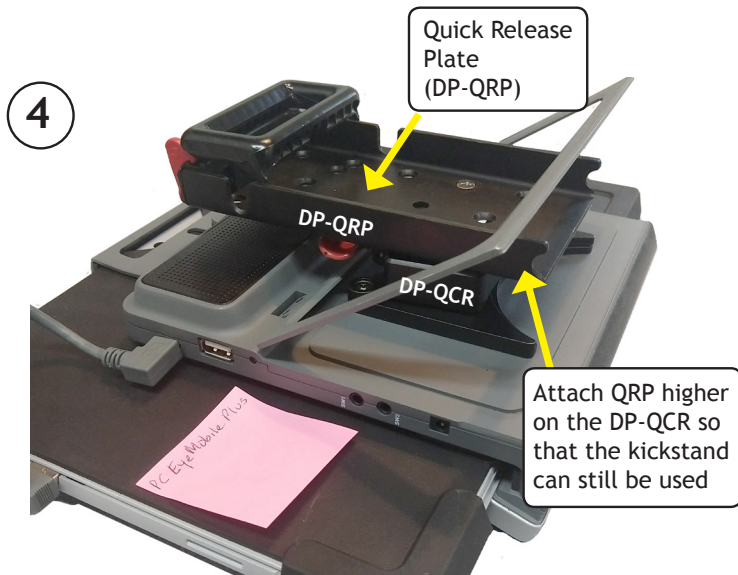

Attach the Quick Release Plate (QRP) to the DP-QCR. Use 4 screws provided with the QRP (8-32-1/4") "QRP to Device Plate"



Attach the QRP to the Tilt Plate on the Mount'n Mover arm.



If your Mount'n Mover has the Quick Connect Receiver (DP-QCR) instead of the Tilt Plate you can attach directly to Tobii's Quick Release Adapter Plate.

Tobii Dynavox Indi

Custom Quick Connect Receiver attachment

The custom Quick Connect Receiver includes four attachment screws to attach to the Quick Release Plate. Fasten the Quick Connect Receiver to the top four countersunk holes in the Quick Release Plate using the screws provided.

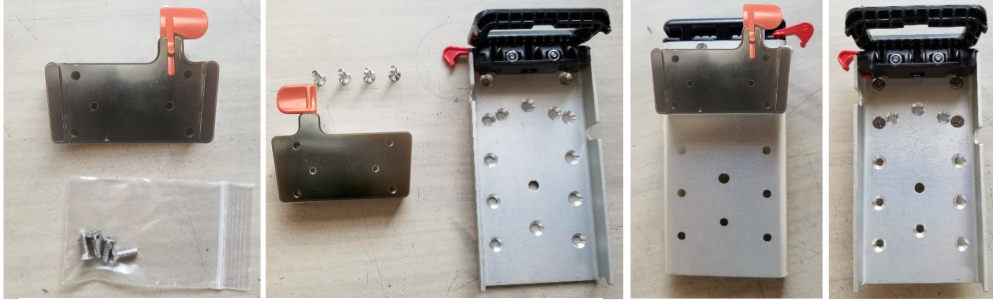

Attaching the Tobii Dynavox Indi to the Quick Connect Receiver



The Indi device (with mounting boot) has mounting slots compatible with the Quick Connect Receiver



Slide the device down until you hear a click or see that the locking lever has engaged. Pull up on the device to check that it is secure.



To attach, position the device to engage the slots, ensuring that both slots are engaged

Removing the Tobii Dynavox Indi from the Quick Connect Receiver



Locate the release lever (circled in red)

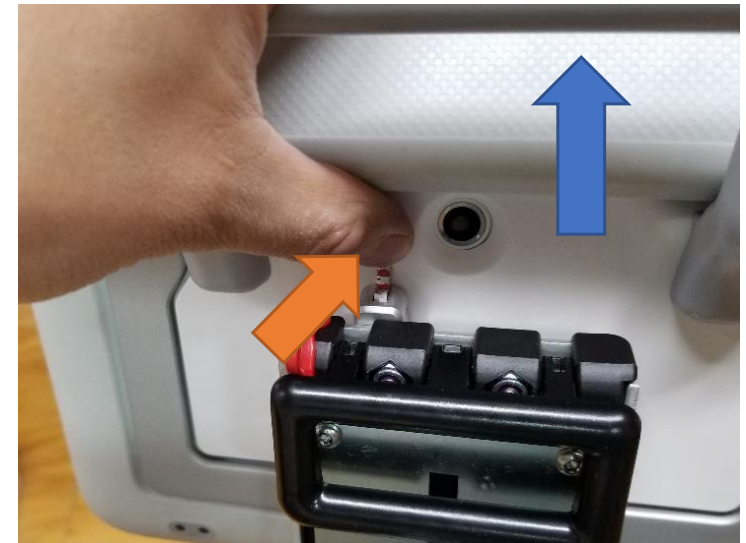

While depressing the lever, pull up on the device for removal.