

Quick Connect Receiver (QCR) Instructions

(Attaching the QCR to Nova Chat 8)

Included Hardware:

QRP to DP-QCR



(X4) 8-32 x 1/2" Screws

NOVA CHAT 8
OFFSET HARDWARE

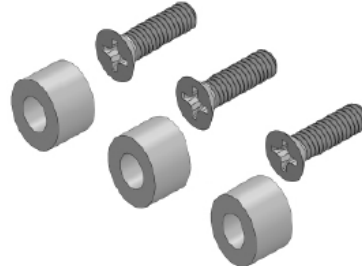

(X3) 6-32 x 1/2" Screws
(X3) 3/16" Nylon Spacers



Attaching the Quick Connect Receiver (QCR) to the Quick Release Plate (QRP)

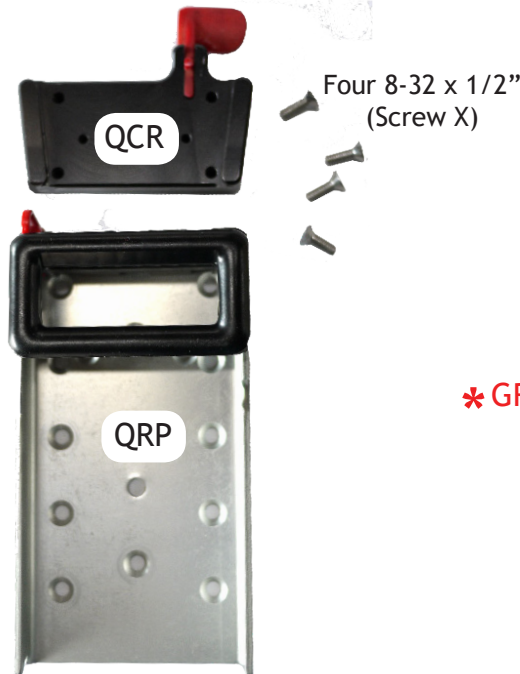

① Quick Connect Receiver (QCR) and the Quick Release Plate (QRP) and hardware four screw X.

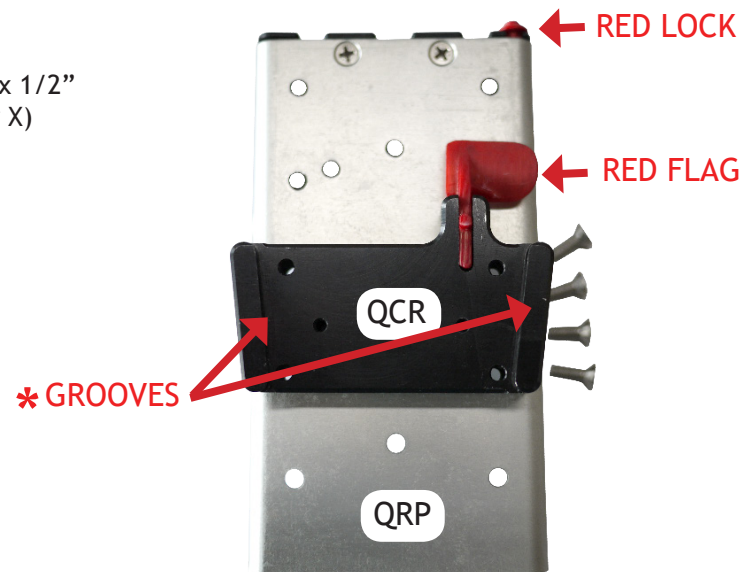

② Line up four holes in the QCR with corresponding holes in the QRP. * Note the grooves in the QCR are facing out. The red lock on the QRP and the red flag on the QCR are facing up.

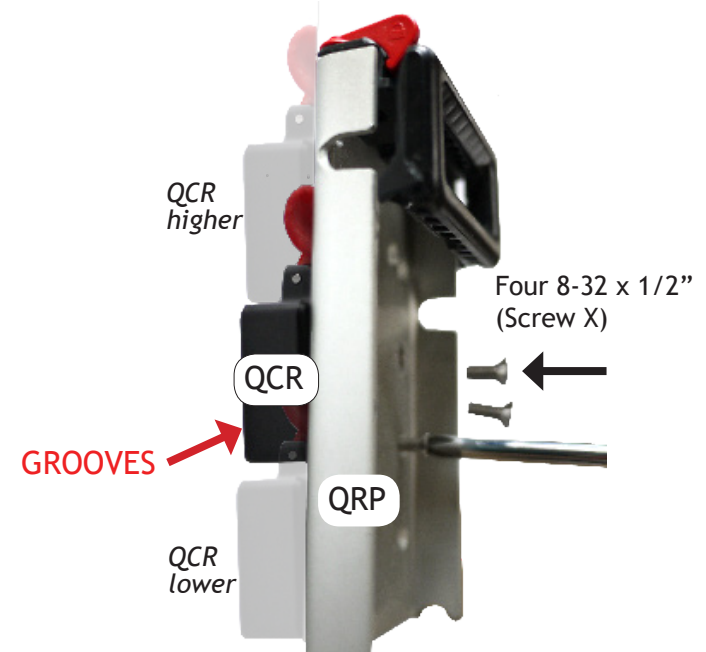

③ Feed the four 8-32 x 1/2" screws through the inside of the QRP and into the back of the QCR. The hole spacing in the QRP allows adjustment higher or lower depending on preference

Nova Chat 8 Attachment Instructions (Attaching to Easy Mover with Quick Connect Receiver)



- ① Remove the screws and plate from the back of the Nova Chat 8

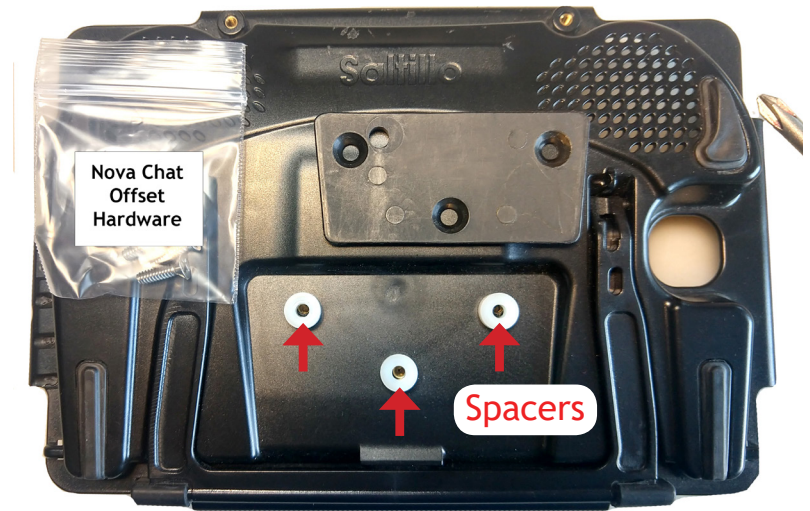

- ② Use spacers and screws from hardware bag labeled "Nova Chat Offset Hardware". Place spacers over threaded holes.



- ③ Place plate over the spacers and reattach to the back of the Nova Chat 8 with the longer screws included in the hardware bag.



Close up view of the spacers underneath the attachment plate.



- ④ Nova Chat 8 mounted to the Easy Mover with Quick Connect.

Nova Chat 8 Attachment Instructions (Attaching to Mount'n Mover Arm with Quick Release Plate)

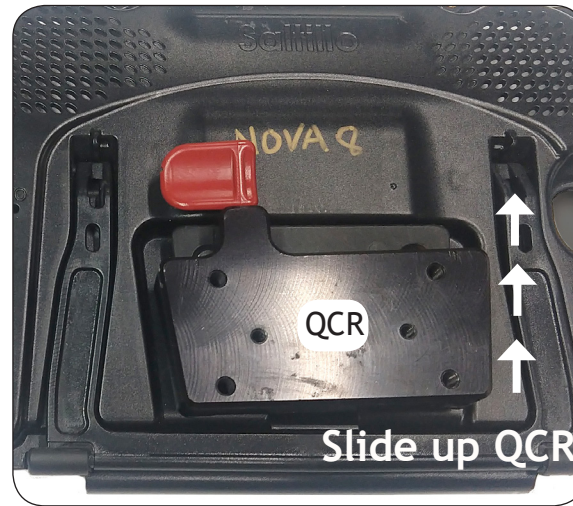

① Install the Nova Chat 8 plate with the spacers underneath (as shown on page 2). Locate the parts shown (QRP, QCR, Screws labeled "QRP to DP-QCR").

② Slide the QCR onto the Nova Chat 8 plate until it "clicks".

③ Place the QRP over the QCR and attach with the four screws labeled "QRP to DP-QCR"



④ Nova Chat 8 attached to the Dual Arm Mount'n Mover with Tilt Plate

* Remove the Nova Chat 8 from the Mount'n Mover at either the QCR (Quick Connect Receiver) or the QRP (Quick Release Plate).