

Quick Connect Receiver (QCR) Instructions

(Attaching the QCR to Nova Chat 8)

Included Hardware:

QRP to DP-QCR



(X4) 8-32 x 1/2" Screws

NOVA CHAT 8 OFFSET HARDWARE

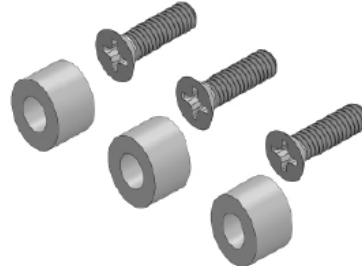

(X3) 6-32 x 1/2" Screws
(X3) 3/16" Nylon Spacers



Attaching the Quick Connect Receiver (QCR) to the Quick Release Plate (QRP)

- A black Quick Connect Receiver (QCR) and a silver Quick Release Plate (QRP) are shown side-by-side. Four 8-32 x 1/2 inch screws are shown between them. The QCR has a red lock on top. The QRP has a red flag on top. The screws are labeled "Four 8-32 x 1/2" (Screw X)".
- The QCR is being attached to the QRP. The QCR is positioned over the QRP. The red lock on the QCR is facing up. The red flag on the QRP is facing up. The QCR is labeled "QCR" and the QRP is labeled "QRP". The red lock is labeled "RED LOCK" and the red flag is labeled "RED FLAG". The grooves in the QCR are labeled "* GROOVES".
- The four 8-32 x 1/2 inch screws are being fed through the inside of the QRP and into the back of the QCR. The QCR is labeled "QCR" and the QRP is labeled "QRP". The screws are labeled "Four 8-32 x 1/2" (Screw X)". The QCR is positioned higher or lower on the QRP, as indicated by the labels "QCR higher" and "QCR lower". The grooves in the QCR are labeled "GROOVES".

Nova Chat 8 Attachment Instructions (Attaching to Easy Mover with Quick Connect Receiver)



- ① Remove the screws and plate from the back of the Nova Chat 8

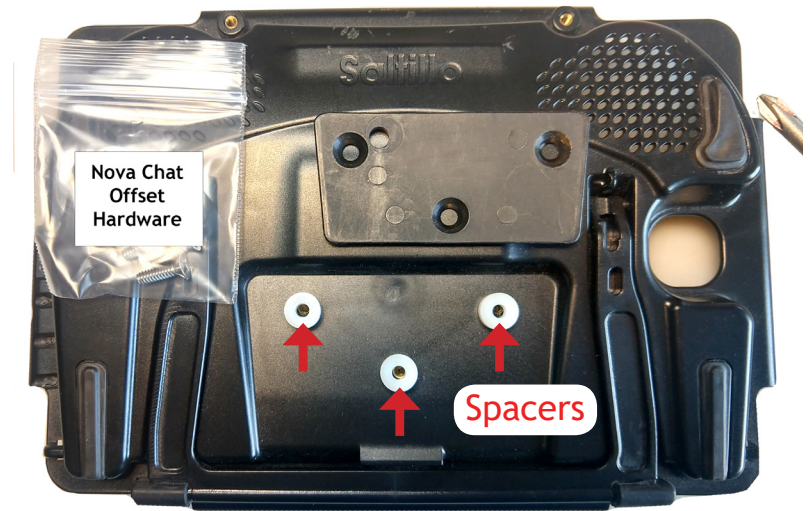

- ② Use spacers and screws from hardware bag labeled "Nova Chat Offset Hardware". Place spacers over threaded holes.



- ③ Place plate over the spacers and reattach to the back of the Nova Chat 8 with the longer screws included in the hardware bag.



Close up view of the spacers underneath the attachment plate.



- ④ Nova Chat 8 mounted to the Easy Mover with Quick Connect.

Nova Chat 8 Attachment Instructions (Attaching to Mount'n Mover Arm with Quick Release Plate)

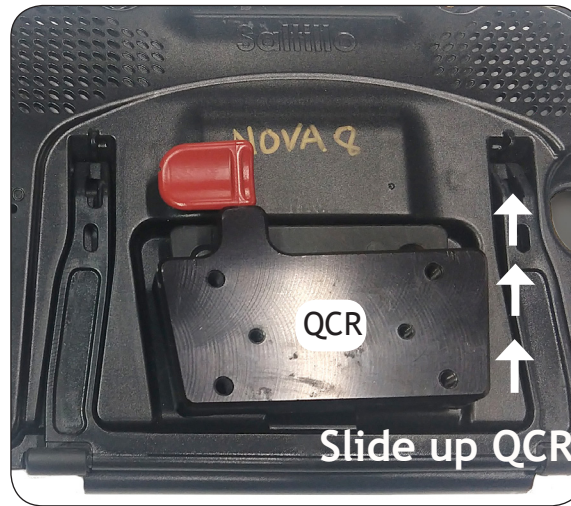

- 1 Install the Nova Chat 8 plate with the spacers underneath (as shown on page 2). Locate the parts shown (QRP, QCR, Screws labeled "QRP to DP-QCR").

- 2 Slide the QCR onto the Nova Chat 8 plate until it "clicks".

- 3 Place the QRP over the QCR and attach with the four screws labeled "QRP to DP-QCR"



- 4 Nova Chat 8 attached to the Dual Arm Mount'n Mover with Tilt Plate



* Remove the Nova Chat 8 from the Mount'n Mover at either the QCR (Quick Connect Receiver) or the QRP (Quick Release Plate).