

# Quick Connect Receiver (QCR) Instructions

(Attaching the QCR to Via Pro 11, Nova Chat 8 and 10, Touch Chat Express, and Prio Mini)

## Included Hardware:

### QRP to DP-QCR



(X4) 8-32 x 1/2" Screws

### PRC - Saltillo Offset Hardware

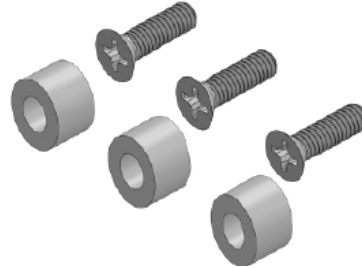

(X3) 6-32 x 1/2" Screws  
(X3) 3/16" Nylon Spacers



## Attaching the Quick Connect Receiver (QCR) to the Quick Release Plate (QRP)

- A diagram showing the QCR and QRP components. The QCR is a black plastic piece with a red lock and a red flag. The QRP is a silver metal plate with four holes. Four 8-32 x 1/2" screws are shown next to the QCR. The text "QCR" and "QRP" are labeled on the respective components. The text "Four 8-32 x 1/2" (Screw X)" is also present.
- A diagram showing the QCR being aligned with the QRP. Red arrows point to the "RED LOCK" and "RED FLAG" on the QCR. A red arrow points to the "GROOVES" on the QCR. The text "QCR" and "QRP" are labeled on the respective components. The text "RED LOCK" and "RED FLAG" are also present.
- A diagram showing the QCR being attached to the QRP. Red arrows point to the "GROOVES" and "QCR higher" and "QCR lower" positions. The text "QCR" and "QRP" are labeled on the respective components. The text "GROOVES" and "QCR higher" and "QCR lower" are also present. A note says "Use this lower attachment option when attaching for the Touch Chat Express or the PRiO Mini". The text "Four 8-32 x 1/2" (Screw X)" is also present.

# Nova Chat 8 Attachment Instructions (Attaching to Easy Mover with Quick Connect Receiver)



- ① Remove the screws and plate from the back of the Nova Chat 8

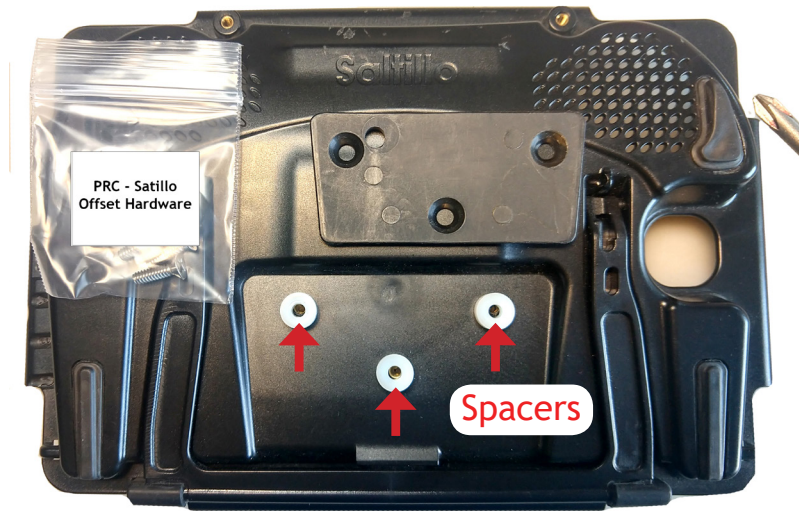

- ② Use spacers and screws from hardware bag labeled "PRC-Saitillo Offset Hardware". Place spacers over threaded holes.

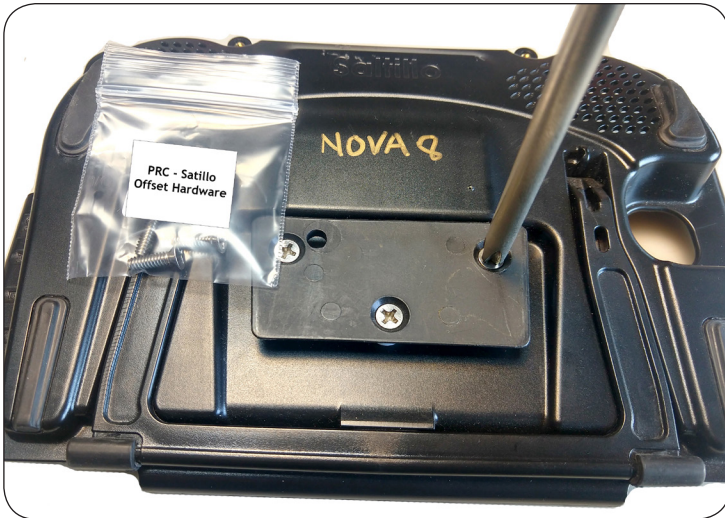

- ③ Place plate over the spacers and reattach to the back of the Nova Chat 8 with the longer screws included in the hardware bag. (6-32 x 1/2")



Close up view of the spacers underneath the attachment plate.



- ④ Nova Chat 8 mounted to the Easy Mover with Quick Connect.

# Nova Chat 8 Attachment Instructions (Attaching to Mount'n Mover Arm with Quick Release Plate)



- 1 Install the Nova Chat 8 plate with the spacers underneath (as shown on page 2). Locate the parts shown (QRP, QCR, Screws labeled "QRP to DP-QCR").

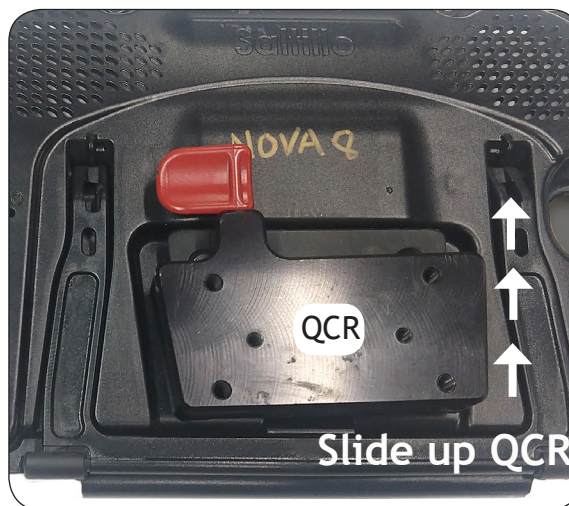

- 2 Slide the QCR onto the Nova Chat 8 plate until it "clicks".

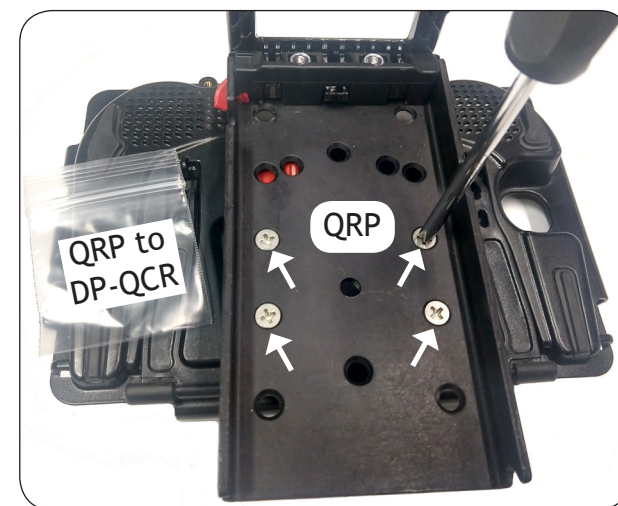

- 3 Place the QRP over the QCR and attach with the four screws labeled "QRP to DP-QCR"



- 4 Nova Chat 8 attached to the Dual Arm Mount'n Mover with Tilt Plate



\* Remove the Nova Chat 8 from the Mount'n Mover at either the QCR (Quick Connect Receiver) or the QRP (Quick Release Plate).

\*Need Offset Hardware: DAH-Salttillo {(x3) 6-32x1/2" flat head screws and (x3) 3/16" nylon spacers}

## Via Pro 11 and Nova Chat 10 (Nova chat 8 uses same back as Via Pro 11)



Remove black PRC attachment plate. Place three 3/16" spacers over the holes.



Re-attach the PRC plate over the spacers using the three screws provided "PRC-Salttillo offset hardware" (6-32 x 1/2")



Showing the DP-QCR (Quick Connect Receiver) attached to the Via Pro 11



Showing the QRP (Quick Release Plate) attached to the QCR (Quick Connect Receiver) and then to the Via Pro 11

\*For attaching QRP to QCR see instructions on page 1

## Touch Chat Express and PRiO Mini



Remove black plate, place spacers, reattach with longer screws (6-32x1/2")



Showing attached to the QCR and QRP.